



# INSTALLATION GUIDE

## RESYSTA RHOMBUS SIDING SYSTEM



### 1. Introduction

#### Sec.1 Material

#### Components

#### Sec.2 Basics

#### Sec.3 Scope of Profiles

### 2. Installation – Procedure

#### Sec.1 Batten

#### Substructure

#### Sec.2 Horizontal Siding

#### Application

#### Sec.3 Vertical Siding

#### Application

#### Sec.4 Air Barrier

#### Requirements

#### Sec.5 Finishing Corners

#### Sec.6 Prime and Stain

#### System

### 3. Safety Warning



## 1. Introduction

Resysta is an extremely durable, timber look-alike, decking material. It is resistant to damage from the sun, rain, frost and even salt water. Unlike wood, it requires minimal maintenance and is highly resistant to pests, mould and cracks. Unlike other composite materials, it closely resembles the look and feel of natural wood, with a smooth surface finish. Resysta meets most of the future environmentally sustainable material requirements concerning recycled and fully recyclable materials. Resysta is used for its architectural aesthetic, and not for structural support.

### SECTION 1 Material Components

A combination of these three basic raw materials makes up the simple components that create Resysta. This innovative material offers designers and architects new creative horizons to utilise its compelling and unique appearance.



Approx. 60% RICE HUSK + Approx. 22% COMMON SALT + Approx. 18% MINERAL OIL = RESYSTA

### SECTION 2 Basics



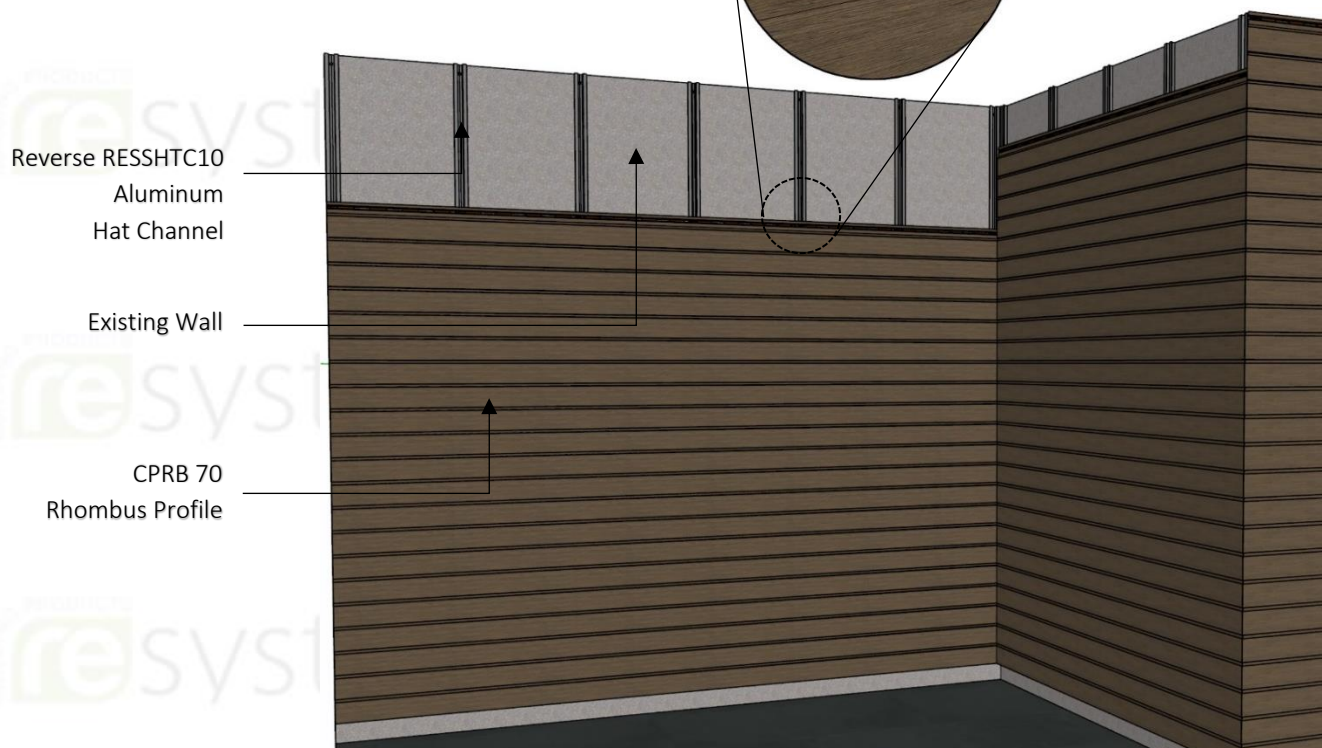

#### OVERVIEW OF PARTS

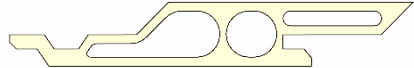
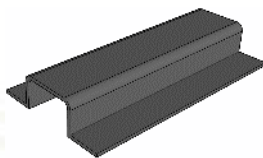

#### ISOMETRIC VIEW

BASIC PARTS OF SIDING BOARD

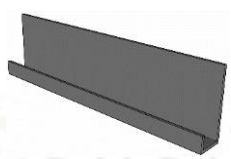
### SECTION 3 Scope of Delivery

NO.	PRODUCT NAME AND SPECIFICATION	ISOMETRIC VIEW	FRONT VIEW
1	<b>CPRB 70</b> 70mm x 20mm x 2900mm Rhombus Profile		
2	<b>RESSHTC10</b> 20mm x 38mm Siding Hat Channel Mill Finish		
3	<b>RESSJS10</b> Starter J-Strip		
4	<b>CPSS 25</b> 25mm Shoulder Stainless Steel Siding Screw		

**Table 1.1 "Scope of Delivery"**

NOTE: Table above shows products commonly used for wall siding. To view a complete list of products, please refer to our Resysta brochure or visit our web site [www.resysta-asia.com](http://www.resysta-asia.com)



## IMPORTANT: Four Major Bullet Points You Must Follow for a Successful Resysta Siding Installation

- **Screw Placement**
- **Room for Expansion and Contraction**
- **Hard Fastening of each Plank**
- **Top to Bottom Ventilation**

### NOTE:

Proper planning of the siding layout is essential for ease of installation of siding boards and siding components. Thoroughly read the following siding assembly instructions and obtain all necessary building permits prior to starting your installation. Decide finishing and trimming options prior to starting the project to ensure siding finishing detail is uniform for all sides of the building. Installation is the sole responsibility of the installer. Resysta Company assumes no responsibility whatsoever with respect to the installation. The information contained herein is provided for guidance purposes only and should not be relied upon as any absolute representation by Resysta.

### Safety Tips:

1. Always check for power, gas, and water lines before installing.
2. Always wear safety glasses when operating power equipment.

### Assembly Tips:

1. Battens should be flat and level to each other. Siding will follow the contour of the wall.
2. Resysta siding system is not a rain screen or water proof system. Resysta siding is a water shed system.
3. Proper wall preparation according to local building codes and wall covering manufacture's recommendations should be adhered to. This includes but is not limited to flashing all openings.
4. All holes should be predrilled and installation holes should be slotted.
5. Only use construction fastening material and hardware suitable for outdoor use (e.g. stainless steel screws). Recommended is the use of shoulder screw.
6. Always consider the linear expansion of Resysta, which is dependent on the temperature but not the air humidity. See Table 1.3 "Resysta Expansion" for more information.
7. Cut-off pieces and/or abrasive dust must be disposed of separately. Please comply with regulations of your competent waste management. You may under no circumstances burn Resysta material.
8. Cutting to length should be carried out at consistent material temperature. Therefore, the material should be stored in the shade or in areas where it is not exposed to direct sunlight. The material can warm up considerably in the sun, leading to an increased change in length. In the case of more distinct fluctuations in material temperature, cutting to length may have to be adapted accordingly.
9. Please store Resysta products flat on level surface.

### Code Compliant Batten Spacing

Part Number	Part Description	Batten Span (mm)	Minimum Steel Gage Size
CPRB 70	Siding Board Flat 70mm x 20mm	400mm	18

**Table 1.2 "Batten Spacing Requirements"**

### Recommendation for Batten Spacing

If the siding is being installed in a hot southern location and will be exposed to direct sunlight for the majority of each day and/or the siding will be stained a dark color, the batten spacing is suggested be reduced to 200mm or 300mm center-to-center for all siding profiles.

### Expansion / Contraction of Siding

Resysta Expansion – Contraction Guide	
Profile Length	2900mm
Expansion / Contraction amount (approx.. 0.3% over 90°C variation in temperature)	10mm

**Table 1.3 Expansion – Contraction:** Average expected expansion – contraction (this can vary based on geographical region).

Resysta Siding Board Gap Guide					
Temperature at Installation	Trim Gap of Siding Boards				H-Channel Gap
	Below 0 °C	15 °C	20 °C	30 °C	
Amount for Siding Profile Length of 2900mm	10mm	7mm	3mm	0mm	6mm

**Table 1.4 "Resysta Expansion"** – Ensure a steady material temperature when cutting the boards to size, i.e. the cutting has to be done under constant conditions, e.g. inside or in shade.

Always consider linear expansion of Resysta profiles during the installation of siding products. If temperatures fluctuate during the installation, the gaps placed between the ends of the boards and a corner, window, or door must change with the temperature. Use the guide above to gap boards during installation.

### Expansion – Contraction Tips:

#### 1) Control Piece

at the start of the day cut a length of board that is desired to be installed and keep this board in the same area as the cutting and storage of the remaining boards. This board will be a "Control Piece" to reference when cutting other boards to be installed. Throughout the day the "Control Piece" can be referenced and the saw cuts adjusted accordingly as the boards expand and/or contract. Heat from the sun will cause Resysta boards to expand so if the material is stored in the shade keep the "Control Piece" in the shade as well.

#### Example:

If 2900mm boards are being installed put aside one 2900mm board at the start of the day. Reference these boards throughout the day and adjust the cutting of the other boards to match

#### 2) Control Gap

at the start of the installation place the siding gap according to Table 1.4 and mark the first gap made. This gap will be a "Control Gap" to reference when gapping the remaining boards to be installed. Throughout the installation reference back to this "Control Gap" to match the other gaps being installed. This will ensure that all the gaps installed are the same.

## 2. Installation - Procedure

### SECTION 1 – Batten Substructure

#### General Notes on Batten Substructure

Resysta siding boards can be installed in horizontal or vertical applications and the batten substructure should be planned to accommodate how the siding boards will be installed.

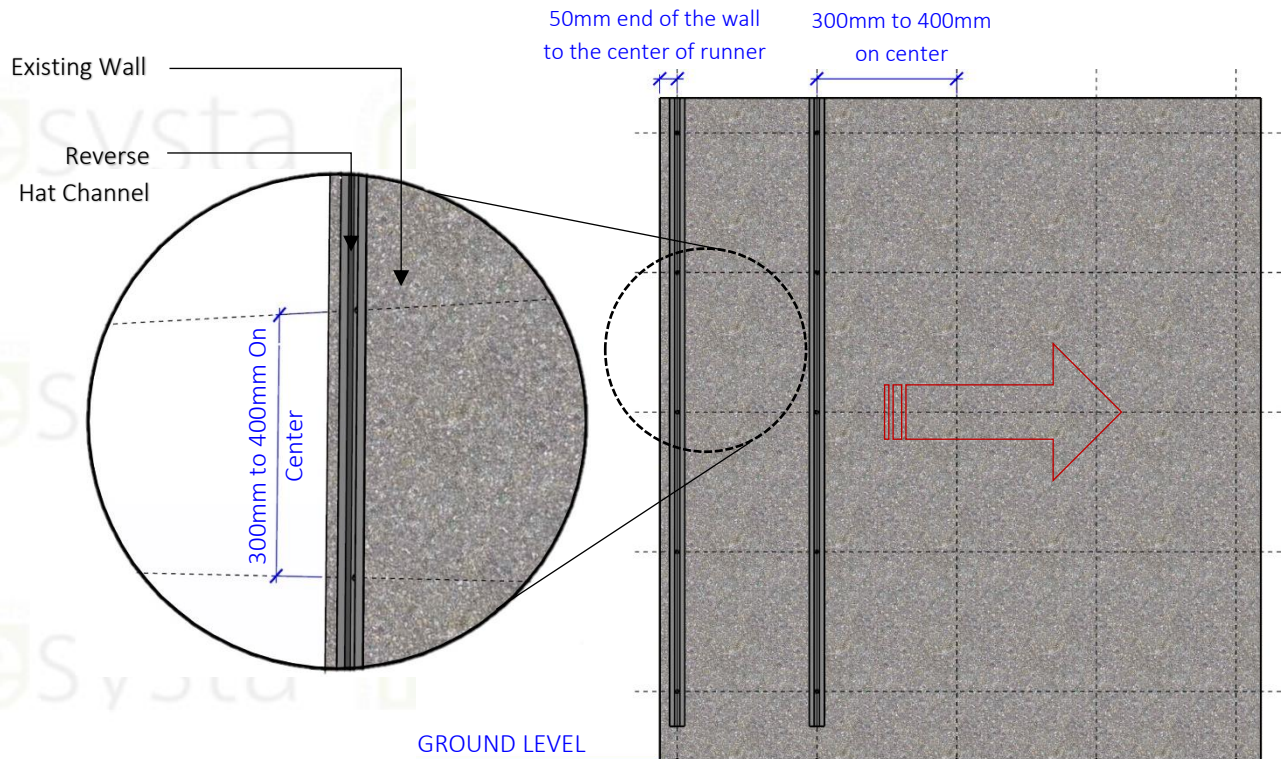

#### FRONT ELEVATION

HORIZONTAL SIDING / VERTICAL BATTENS

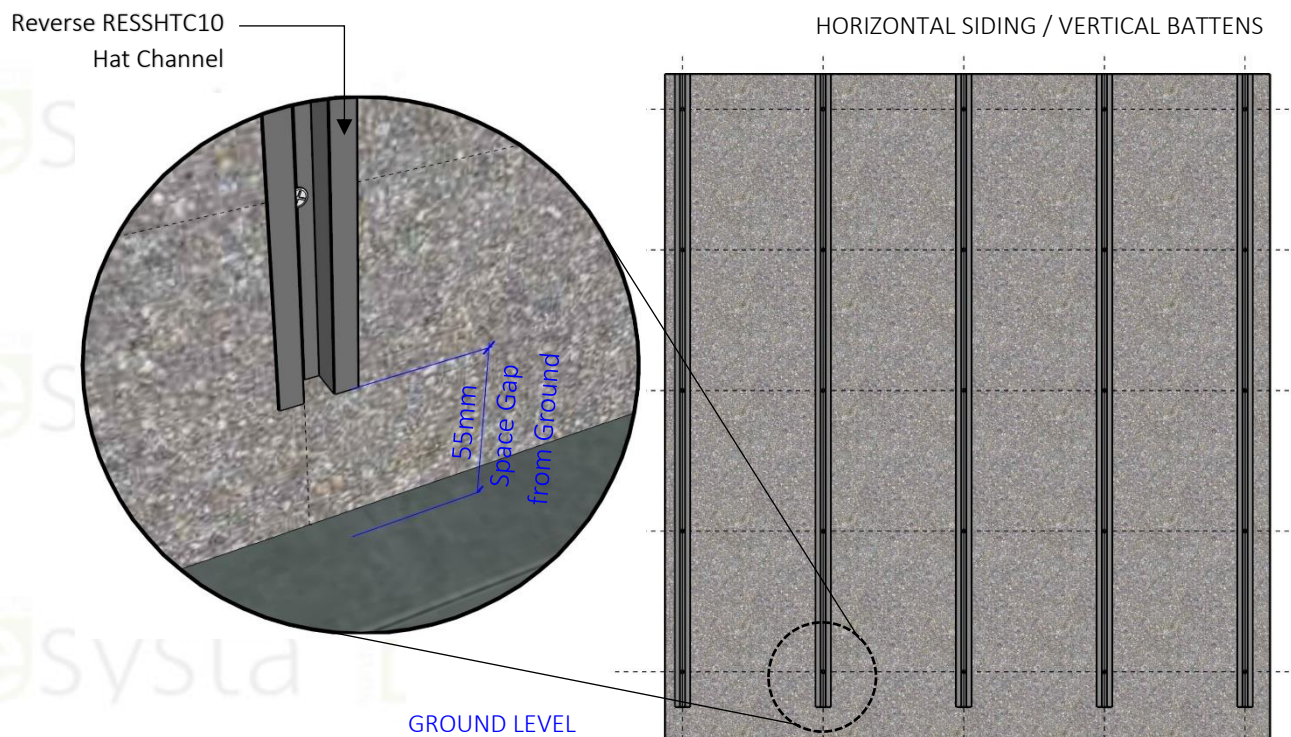

#### FRONT ELEVATION

HORIZONTAL SIDING / VERTICAL BATTENS



Resysta siding boards require a minimum of 75mm from the ground to the start of the siding board in horizontal installations. Plan the batten substructure and wall assembly accordingly to accommodate siding installation while adhering with local building code requirements.

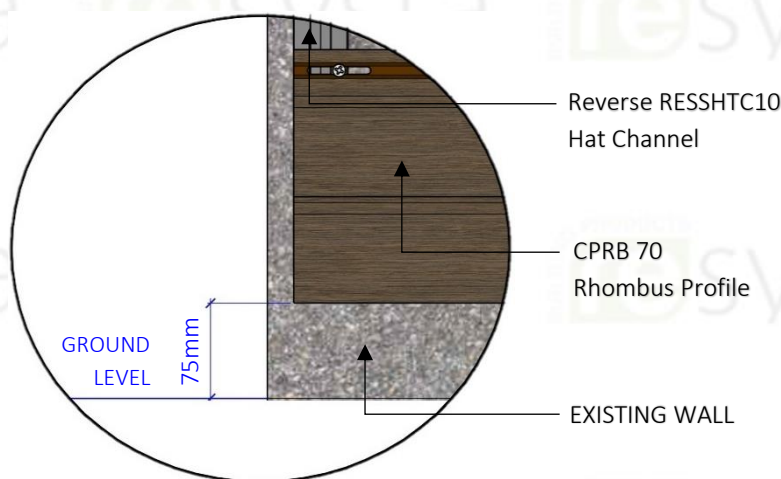

**DETAIL**  
BATTENS DETAIL

### **Resysta Aluminum Batten Substructure**

Install the battens and secure to the frame substructure in compliance with local building codes. Ensure that the installed battens do not exceed the “Batten Spacing Requirements” of Table 1.2. On walls where two siding boards will be used end-to-end, a minimum of two battens must be used to accommodate the fastening of the siding boards and any trim pieces desired to the batten substructure where the boards meet. Prior to installing the Resysta siding boards, ensure that the batten installation provides a minimum 20mm air gap behind the siding boards and there is sufficient support for all siding boards and trim accessories. This is often achieved through the installation of battens with a minimum thickness of 20mm.

Battens should be installed on top of a code compliant sheathing with fasteners and fastener spacing sufficient to accommodate all loads imposed upon it by the Resysta siding board, trim components, and any other accessories attached to the battens. Resysta siding boards must be attached to aluminum battens with Resysta Shoulder stainless steel screws taking care to not penetrate the weather barrier. If the weather barrier is going to be penetrated reference the weather barrier manufacture’s recommendations.

#### **Notes on Resysta Shoulder Screw**

### **Resysta Aluminum Batten Installation Guidelines**

When using metal battens, either steel or aluminum, it is recommended to use the Screw which can be driven through the aluminum siding trim and into the metal batten. Trim should be fastened 400mm on center for either horizontal or vertical installations. If the batten substructure spacing is reduced for the siding boards the trim should be fastened at the same interval as the siding. Be aware of fastener placement for the siding trim so as to not hinder the installation of the Resysta siding boards.

## SECTION 2 – Horizontal Siding Applications

### STEP 2.1

Pre apply all finishing trim accessories such as trim around corners, windows, and doors according to the pre plan layout and following the manufacture's recommendations. Ensure that all trim is level and square. Battens should be installed vertically.

### STEP 2.2

Aluminum starter strip is required to install the Resysta siding board. Attach the starter strip at the bottom of the battens following the fastener and spacing recommendations in Section 1. The Resysta siding boards will hang 13mm below the bottom of the starter strip therefore the starter strip should be attached accordingly as per the pre plan layout.

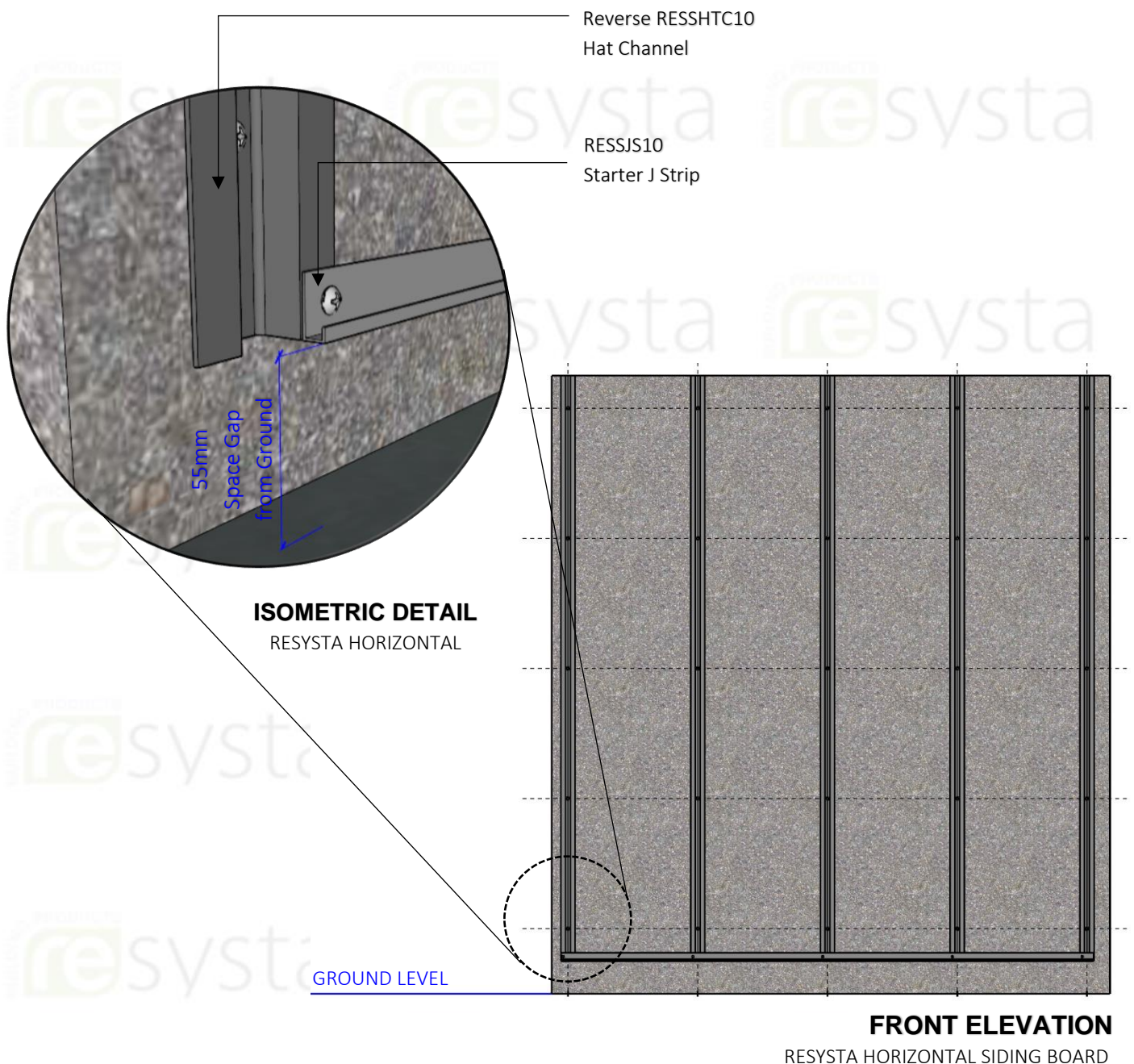



## STEP 2.3

Hook the groove end of the first siding board into the Starter J Strip.

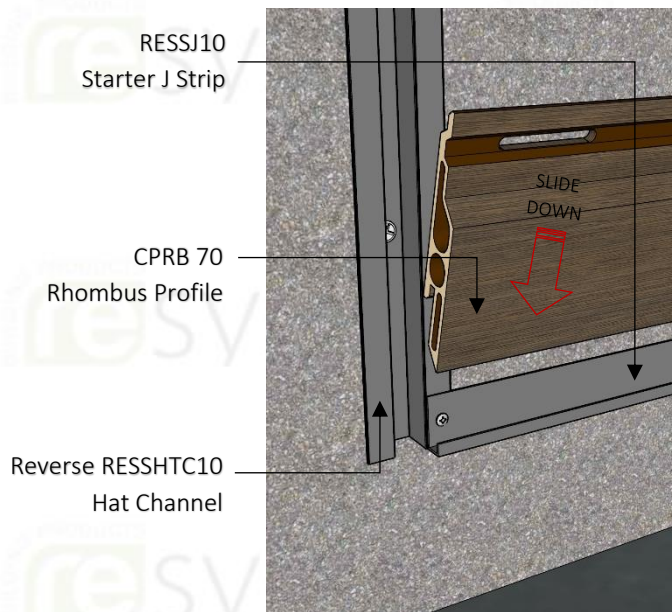

### DETAIL

RESYSTA HORIZONTAL SIDING

#### Step 1

Slide down the first Resysta Siding board into Starter J Strip.

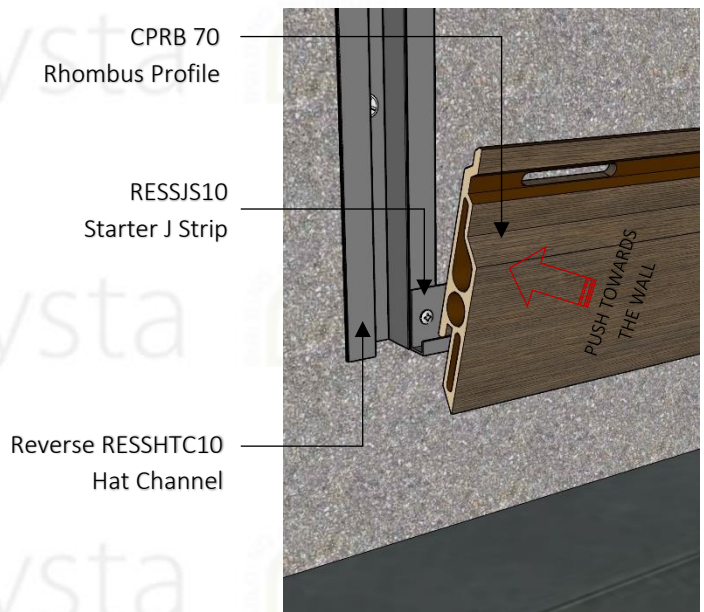

### DETAIL

RESYSTA HORIZONTAL SIDING

#### Step 2

Hook the groove end of the first Resysta Siding board into the Starter J Strip with SS screw.



### DETAIL

RESYSTA HORIZONTAL SIDING

#### Step 3

Push the Resysta Siding board perpendicular into the runner and screw direct to the groove.

## STEP 2.4

Install screws into all slotted holes except the center hole. DO NOT over tighten the screws. The screws should be placed in the center of the slotted hole and loose enough to allow the board to move freely from side to side to allow for expansion and contraction.



### ISOMETRIC DETAIL

RESYSTA HORIZONTAL SIDING BOARD

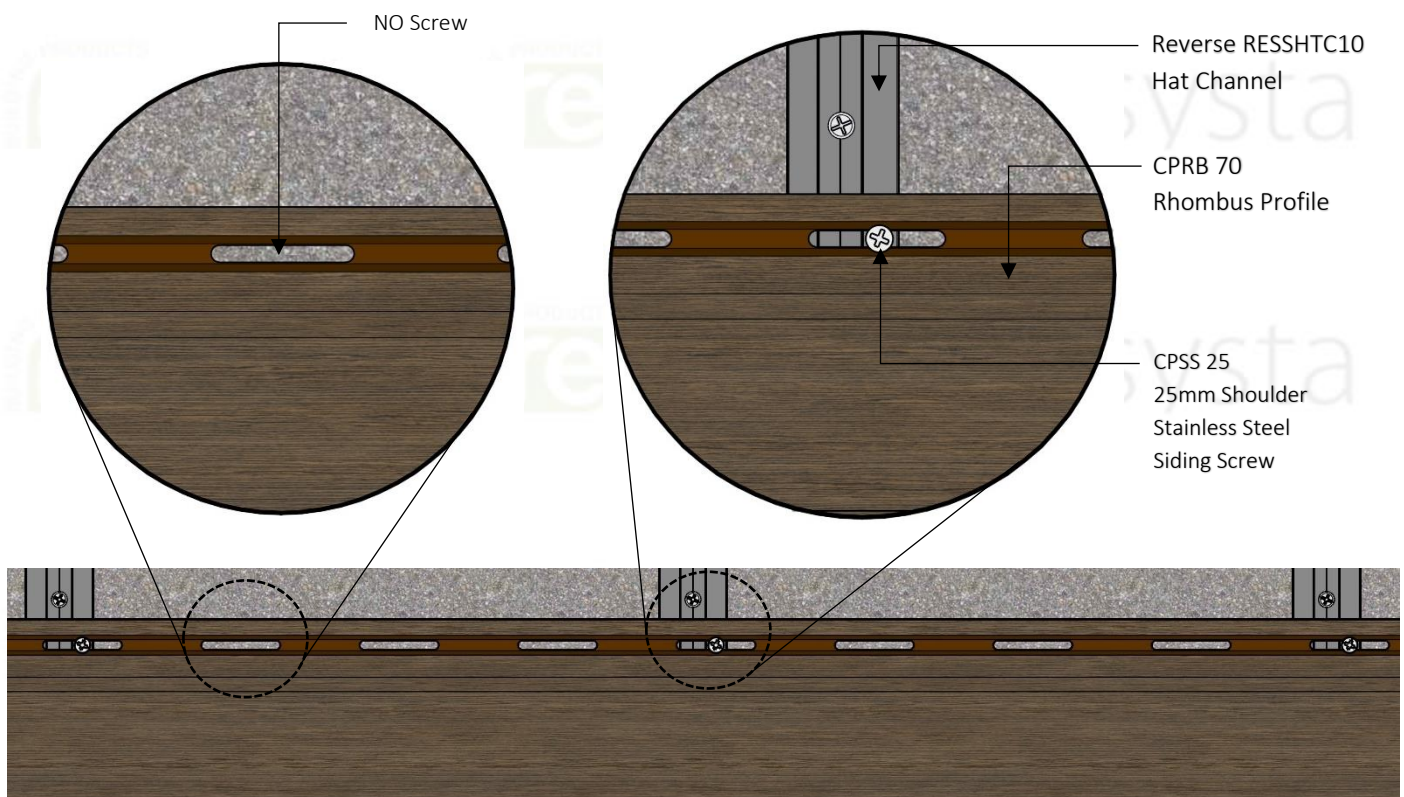

### FRONT ELEVATION

RESYSTA HORIZONTAL SIDING

#### Note

*If installing more than one board in width, please refer to Section 3 – Horizontal Multi Board Siding Applications*



## STEP 2.5

Install the final two screw in the slotted hole in the center of the board. This will allow for expansion and contraction evenly to each side of the assembly.

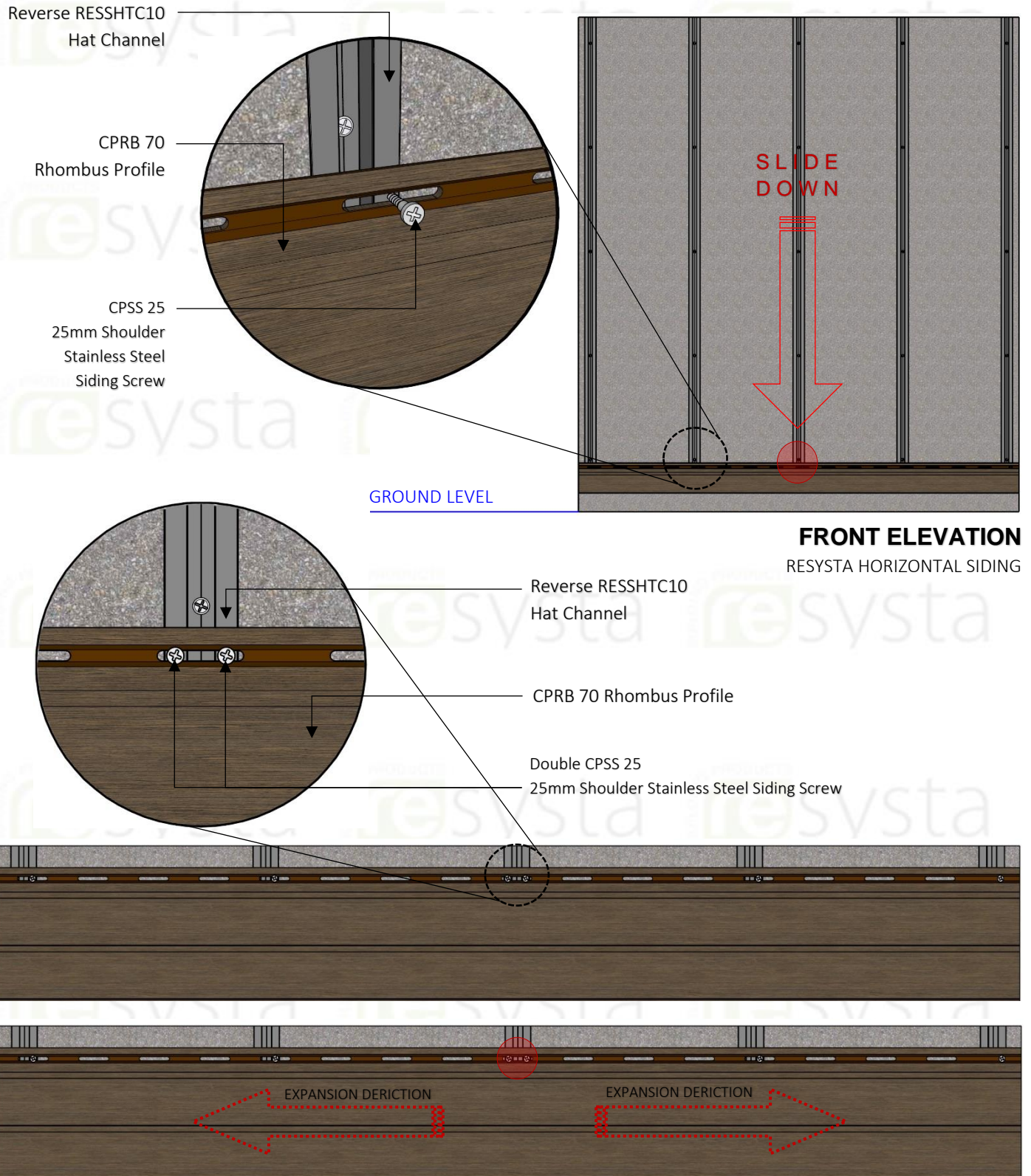

### Pinning Location

Every board should hard pin on the middle of the Resysta Siding board allow for right or left side expansion direction.



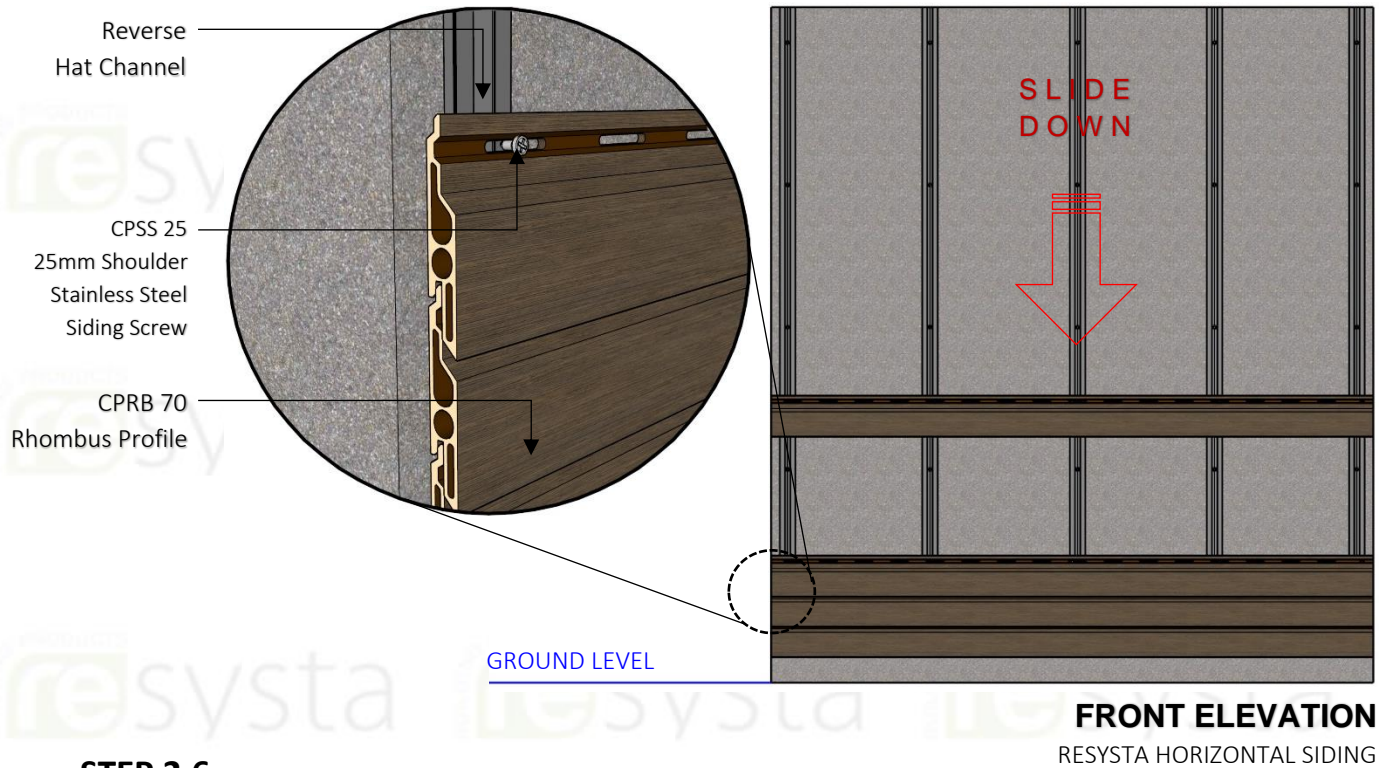

## STEP 2.6

Hook the groove end of the next board onto the tongue of the installed siding board.

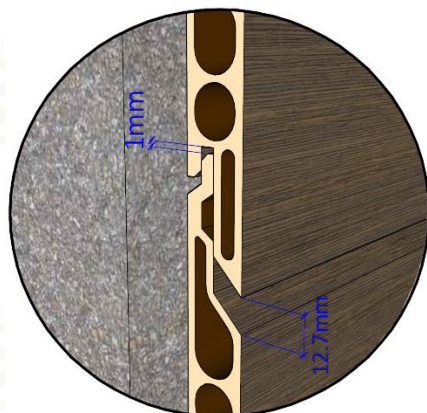

**ISOMETRIC DETAIL**  
RESYSTA HORIZONTAL SIDING

### Note:

Ensure a 1mm gap expansion using shim with a space gap of 13mm from one board to another board.

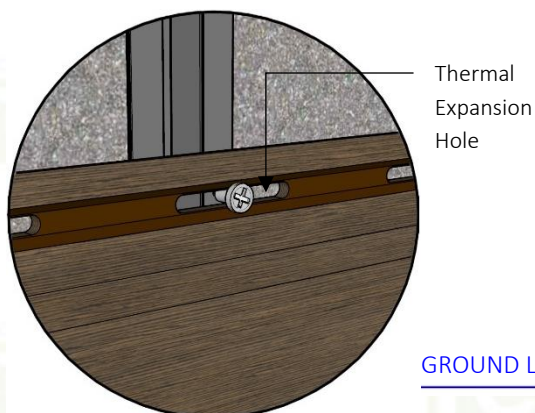

**ISOMETRIC DETAIL**  
RESYSTA HORIZONTAL SIDING

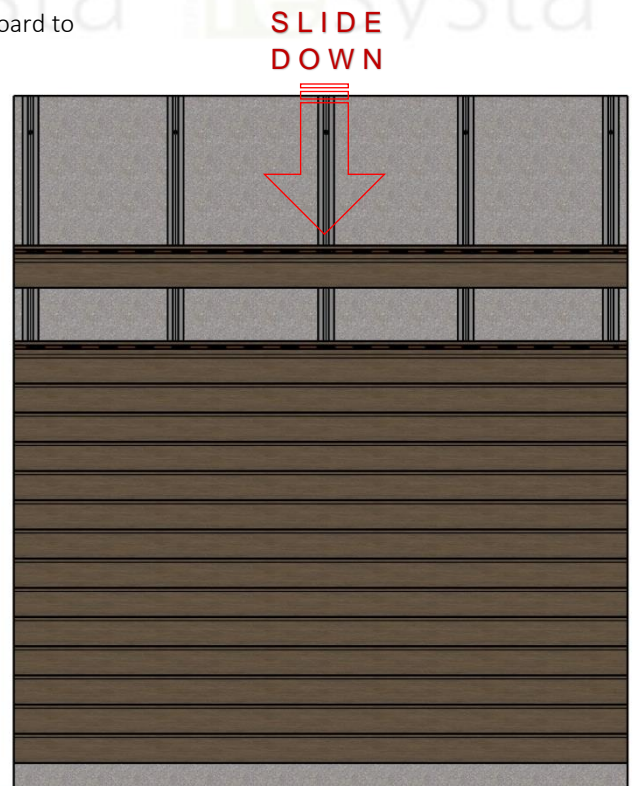

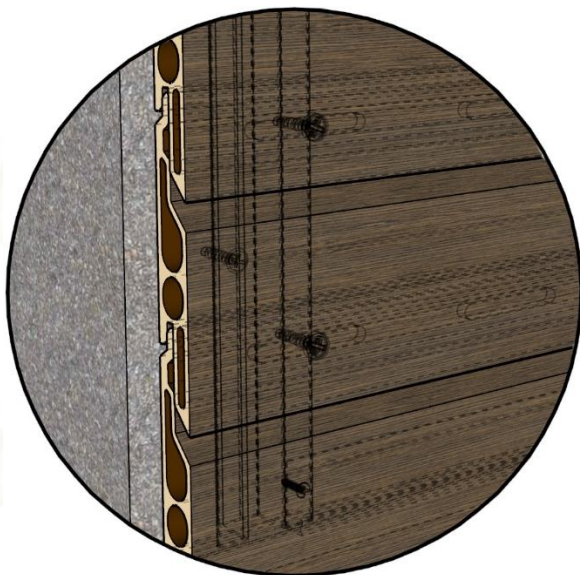

**ISOMETRIC DETAIL**  
RESYSTA HORIZONTAL SIDING

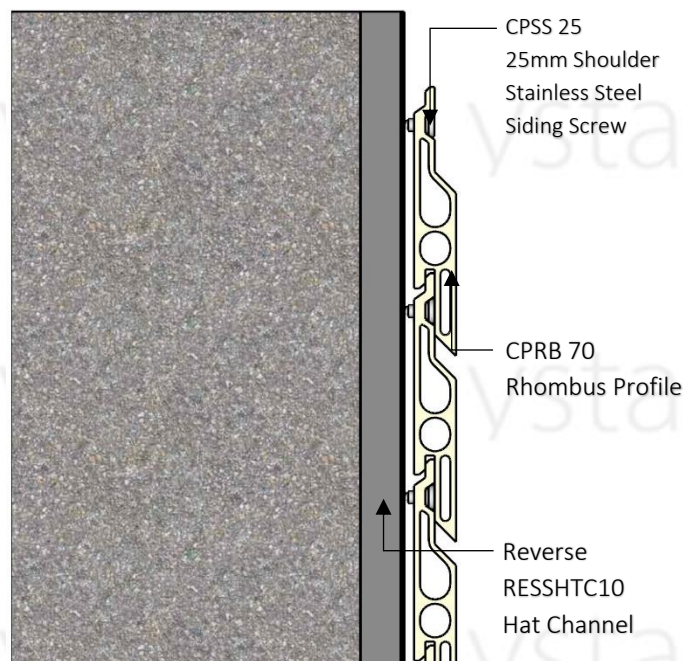

**SECTION**  
RESYSTA HORIZONTAL SIDING

## STEP 2.7

Continue installing siding boards until siding is finished.

GROUND LEVEL



**FRONT ELEVATION**  
RESYSTA HORIZONTAL SIDING



## SECTION 3 – Multi-Board Horizontal Siding Applications

### STEPS 3.1.1

Ensure that two battens have been installed where boards are to be installed end to end.

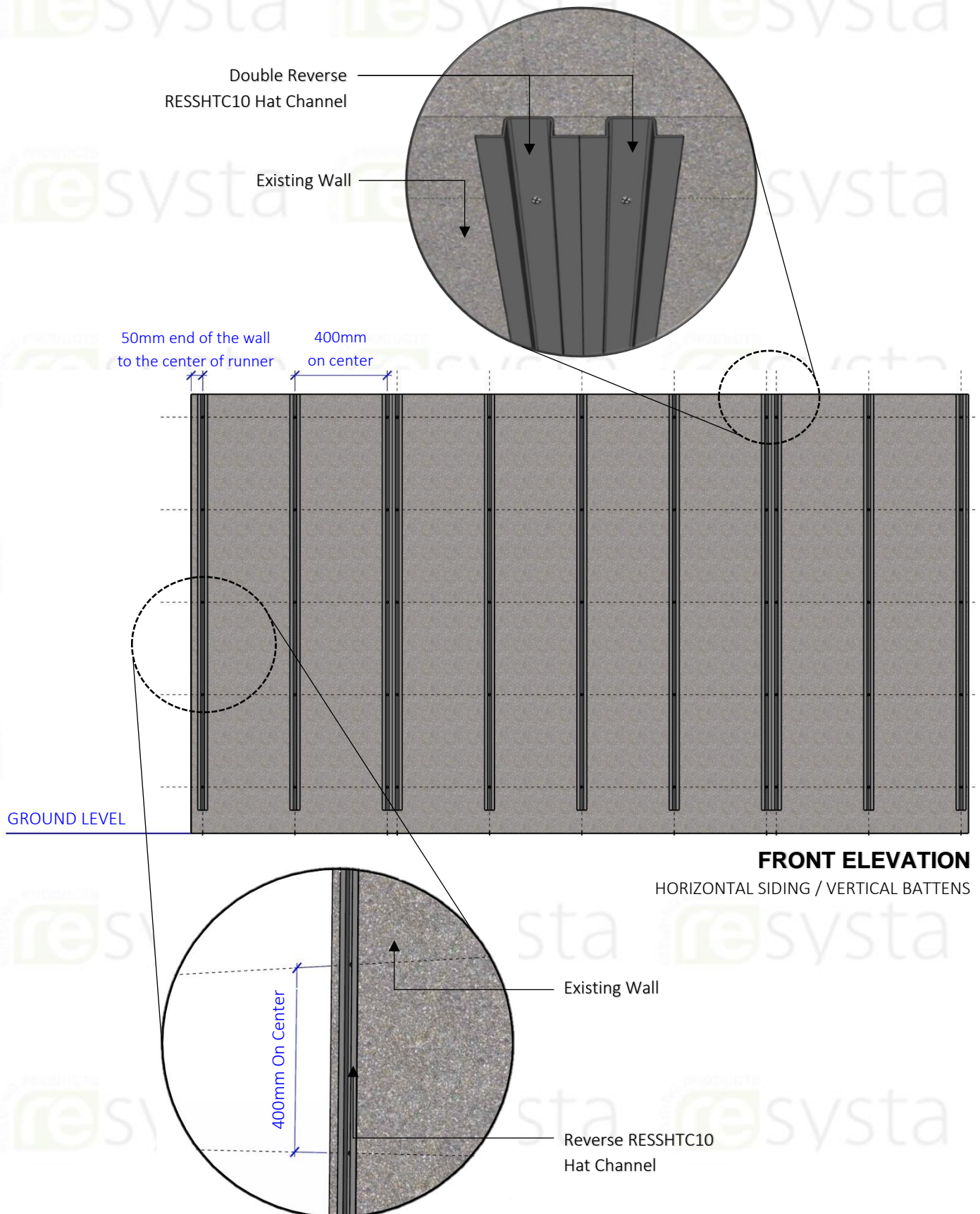



### STEP 3.1.2

Pre apply all finishing trim accessories such as trim around corners, windows, and doors according to the pre plan layout and following the manufacture's recommendations. Ensure that all trim is level and square. Battens should be installed vertically.

### STEP 3.1.3

Aluminum starter strip is required to install the Resysta siding board. Attach the starter strip at the bottom of the battens following the fastener and spacing recommendations in Section 1. The Resysta siding boards will hang 13mm below the bottom of the starter strip therefore the starter strip should be attached accordingly as per the pre plan layout.

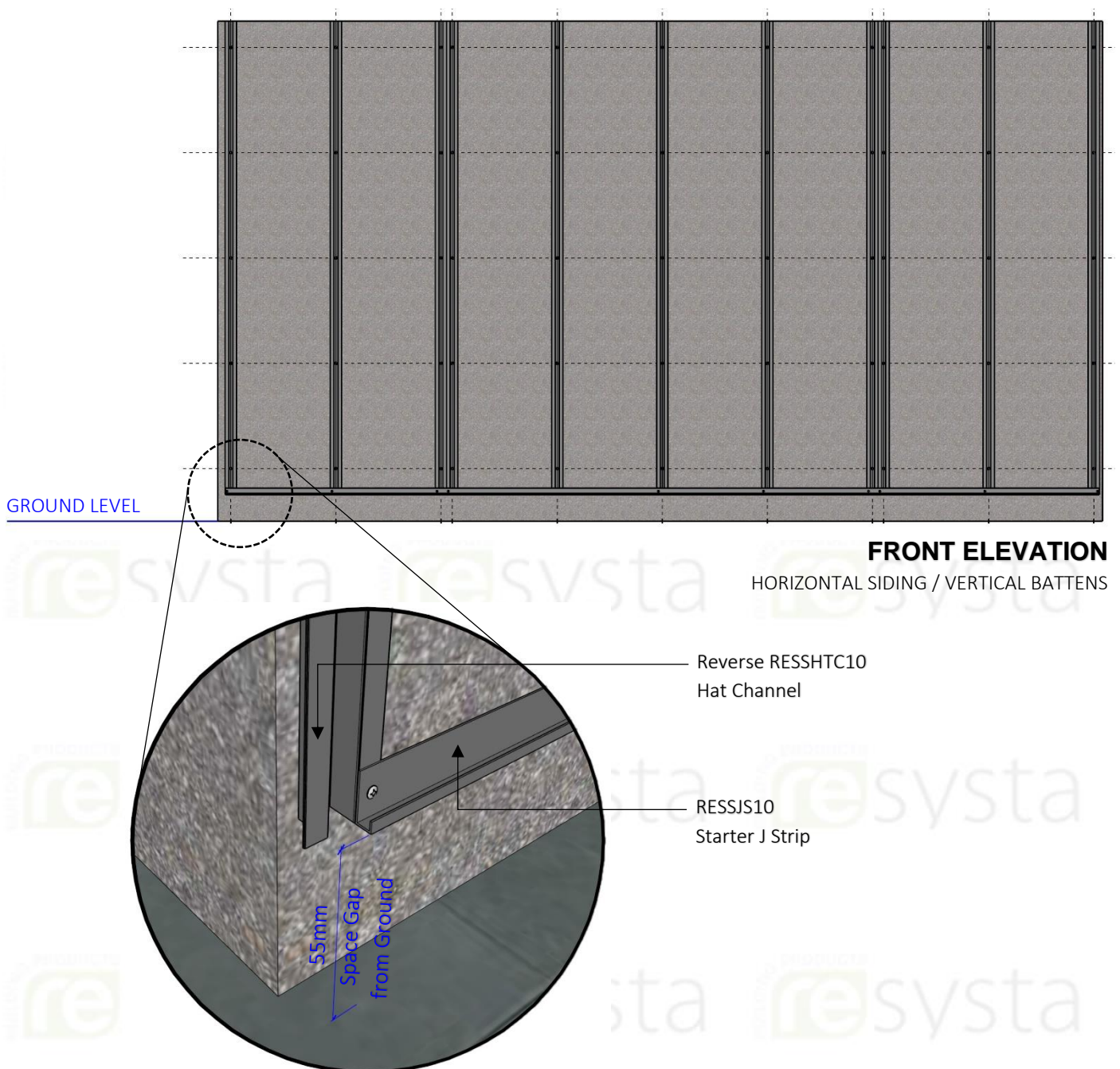

### STEP 3.1.4

Hook the groove end of the first siding board into the Starter J Strip.

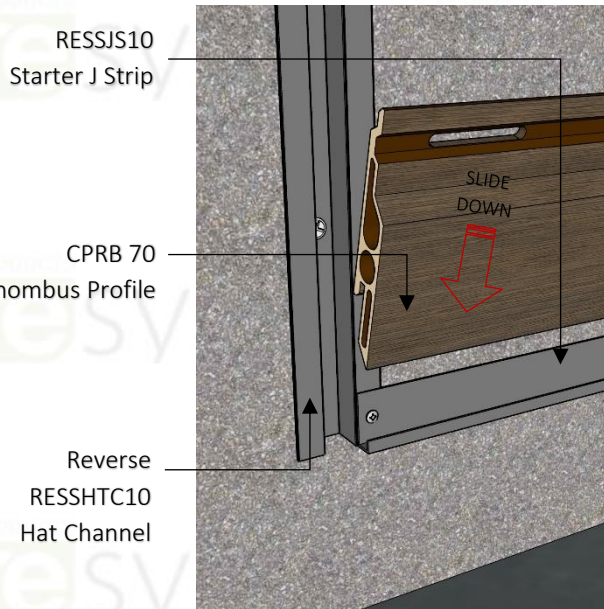

#### DETAIL

RESYSTA HORIZONTAL SIDING

#### Step 1

Slide down the first Resysta Siding board into Starter J Strip.

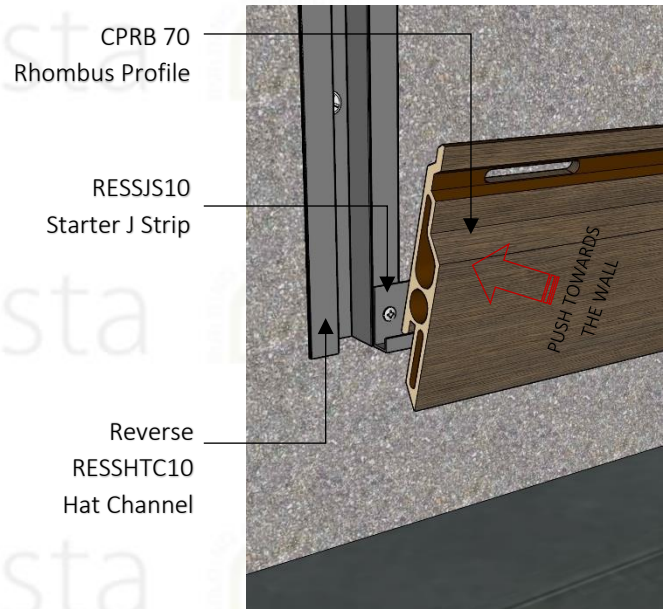

#### DETAIL

RESYSTA HORIZONTAL SIDING

#### Step 2

Hook the groove end of the first Resysta Siding board into the Starter J Strip with SS screw.

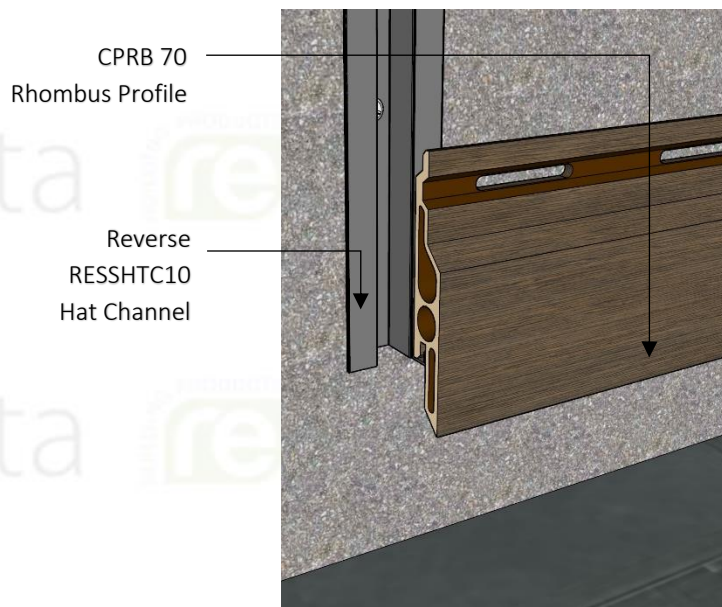

#### DETAIL

RESYSTA HORIZONTAL SIDING

#### Step 3

Push the Resysta Siding board perpendicular into the runner and screw direct to the groove.



### STEP 3.1.5

Install screws into all slotted holes except the center hole. DO NOT over tighten the screws. The screws should be placed in the center of the slotted hole and loose enough to allow the board to move freely from side to side to allow for expansion and contraction.

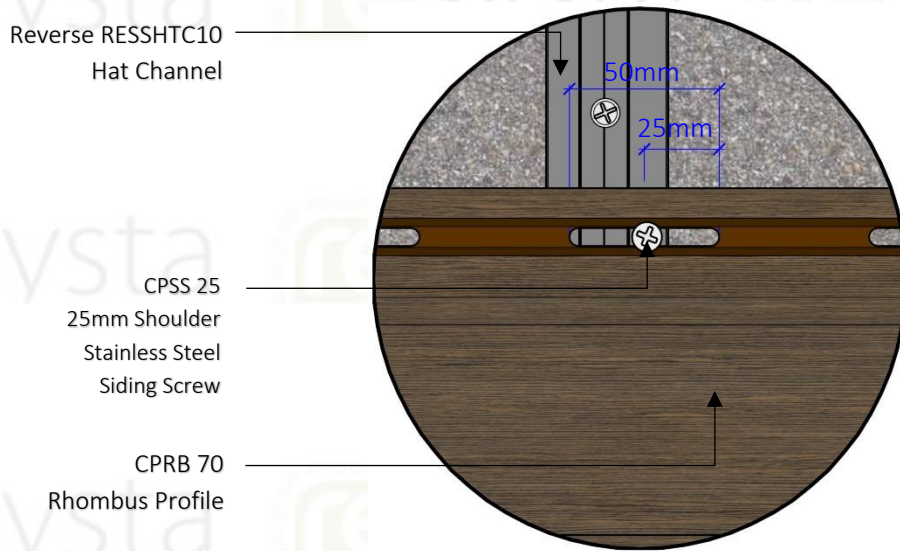

#### ISOMETRIC DETAIL

RESYSTA HORIZONTAL SIDING BOARD

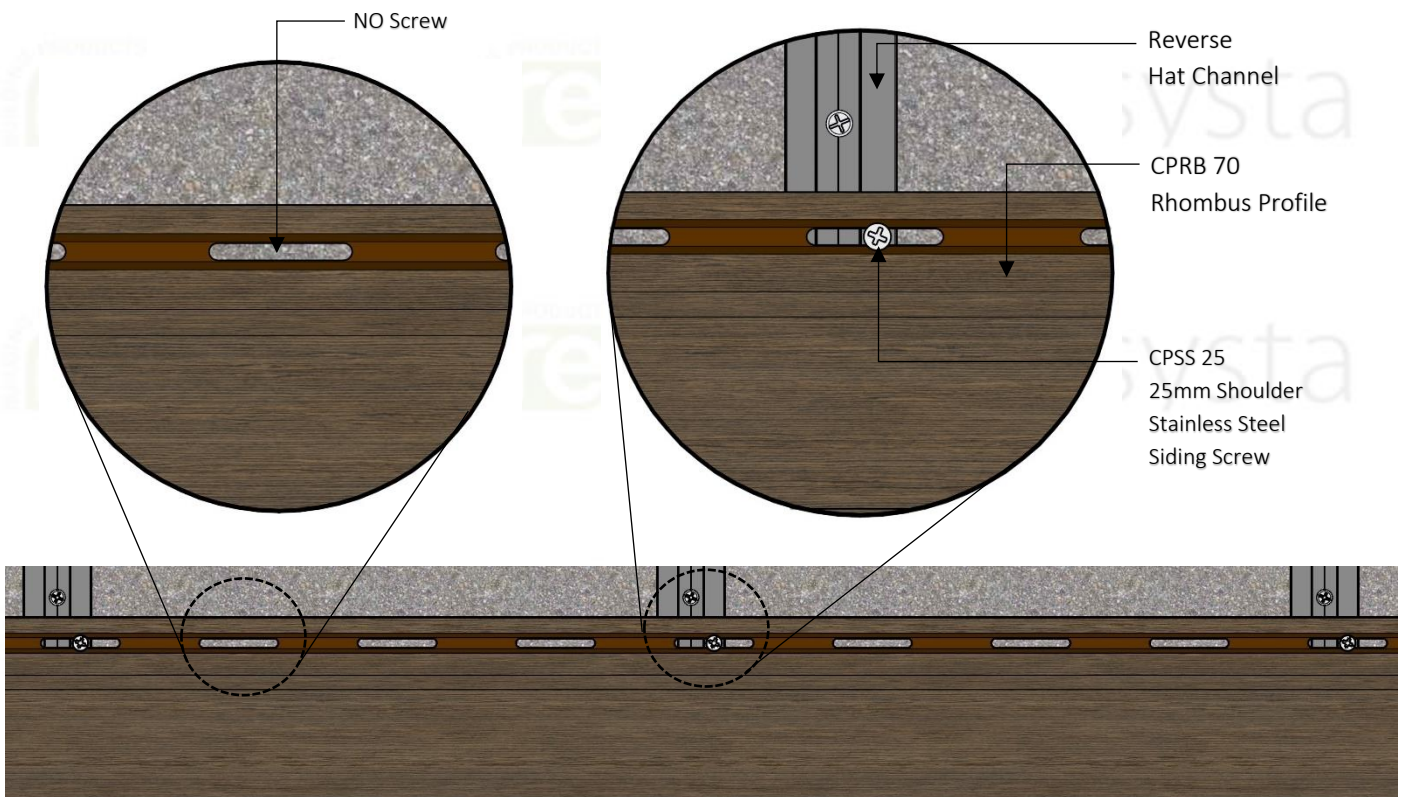

#### FRONT ELEVATION

RESYSTA HORIZONTAL SIDING



### STEP 3.1.6

Install screws into all slotted holes except the hole closest to the abutted joint on both siding boards. DO NOT over tighten the screws. The screws should be placed in the center of the slotted hole and loose enough to allow the board to move freely from side to side to allow for expansion and contraction.

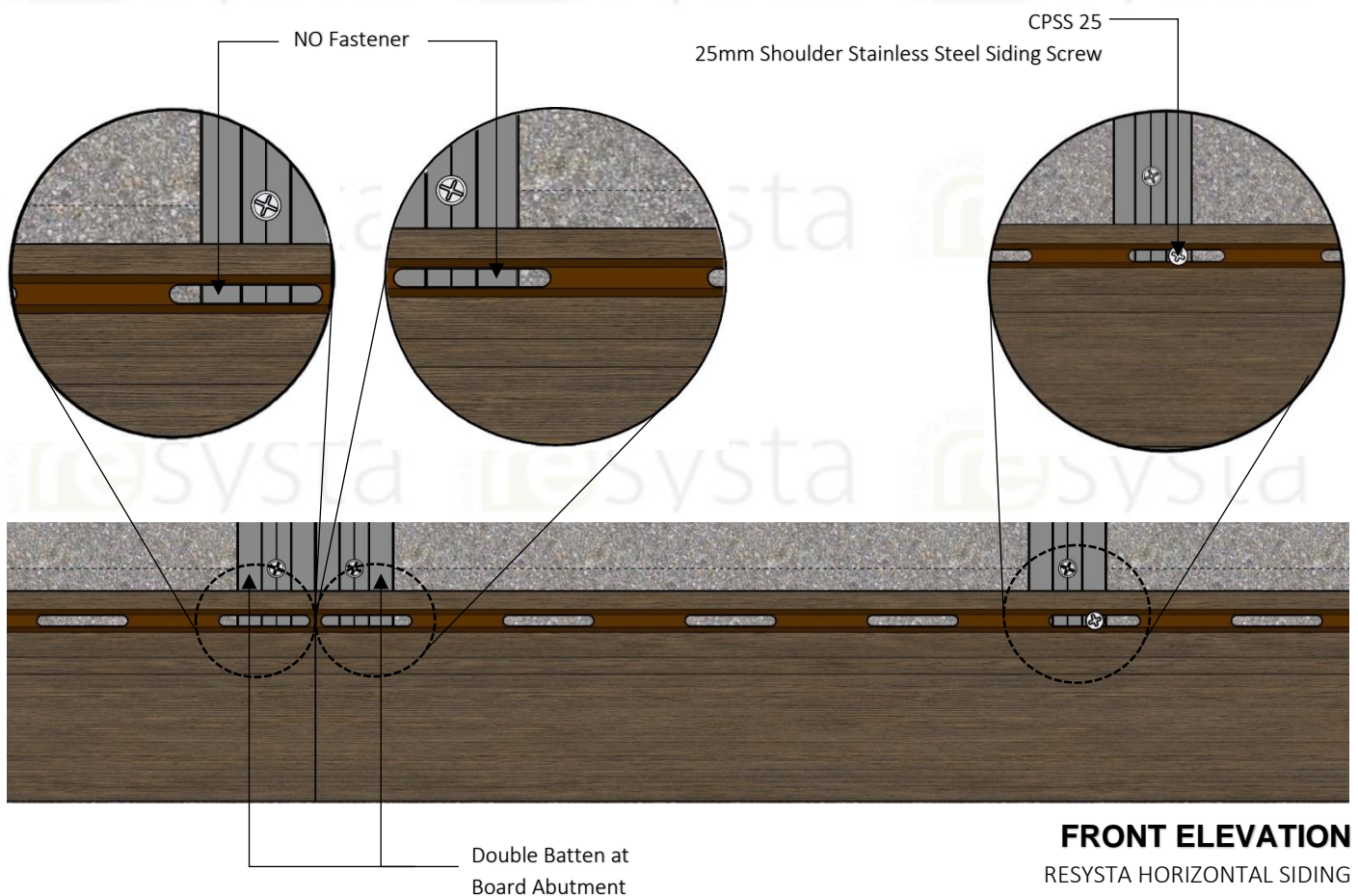
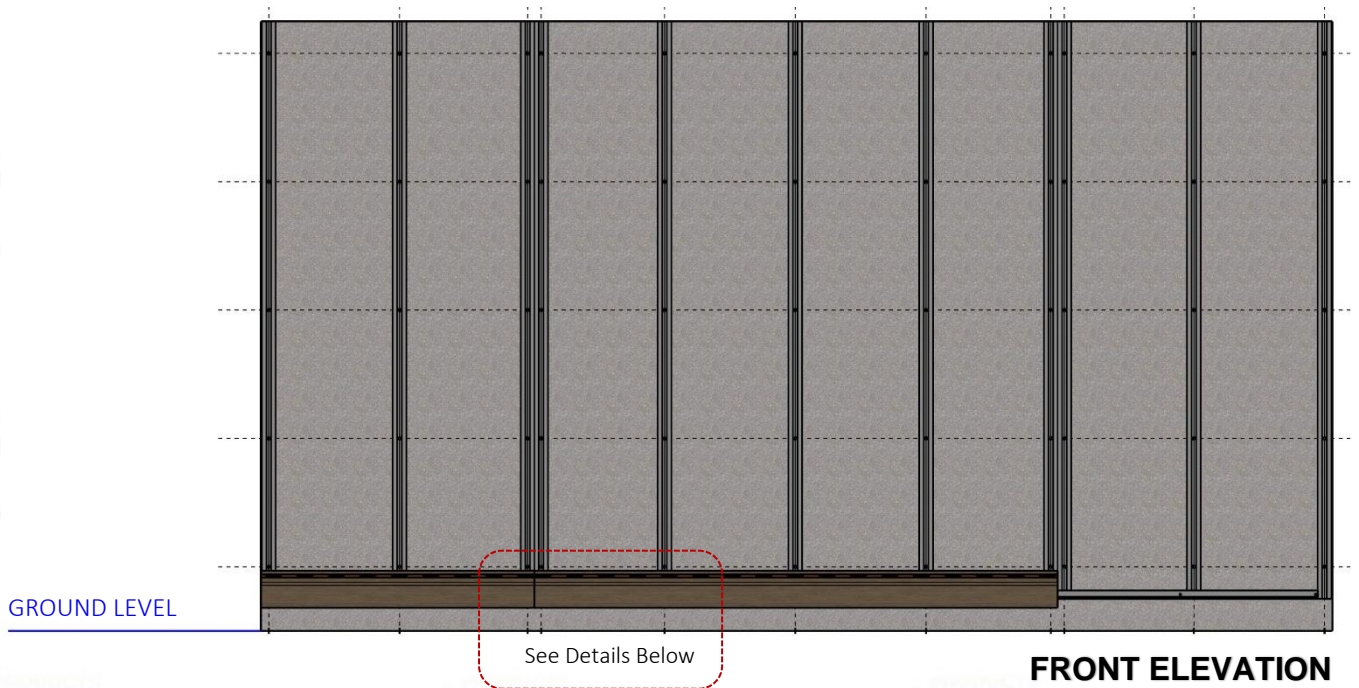

### STEP 3.1.7

Install one screw in the slotted hole closest to the abutted joint on both siding boards. The siding board should be secured down at the double batten location with the fastener a maximum of 50mm away from the edge. This will control expansion and contraction evenly to the outside of the siding boards while keeping the abutting joint snug.

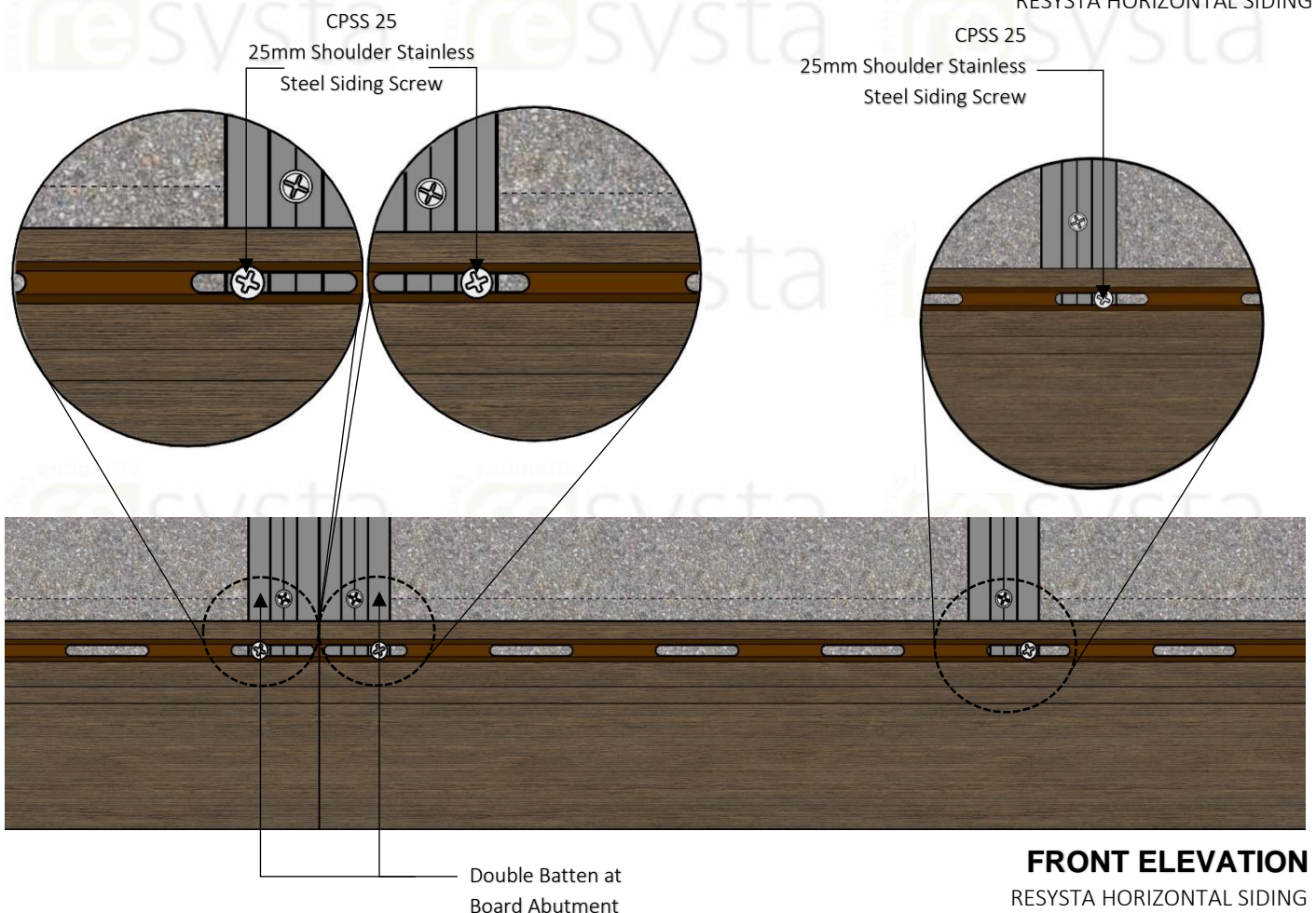
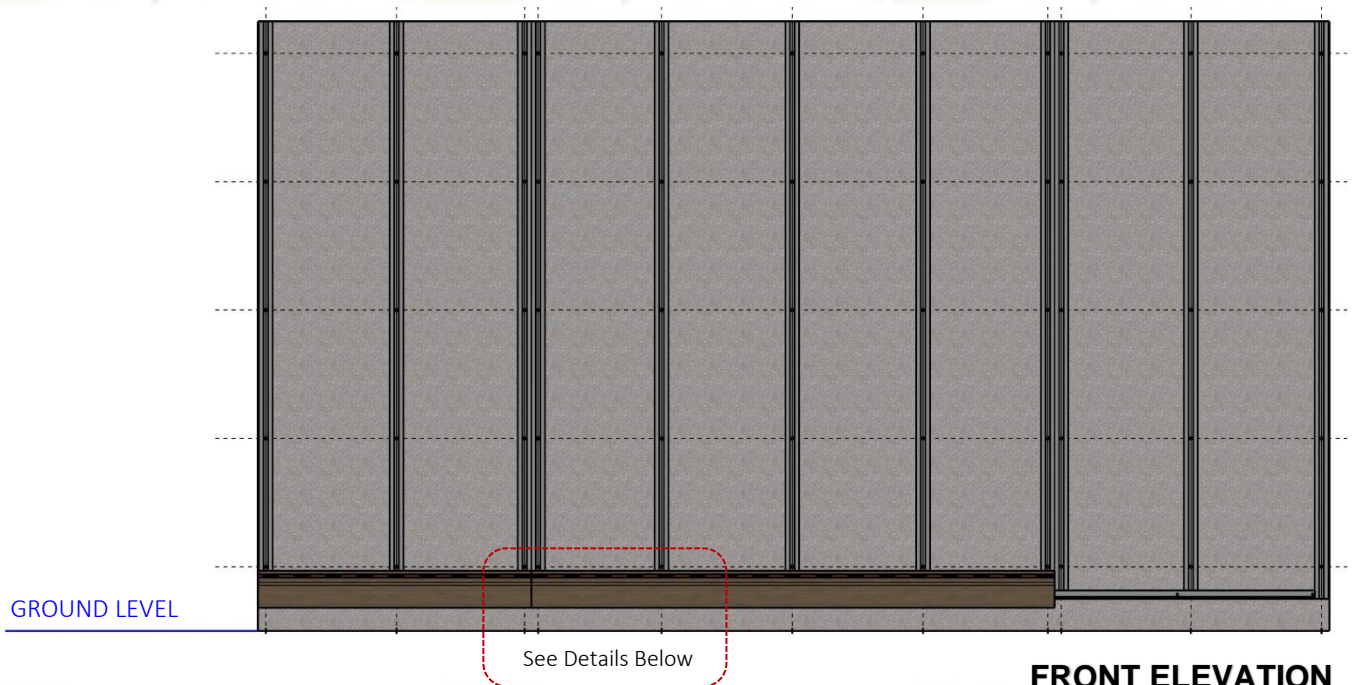



### STEP 3.1.8

Hook the groove end of the next board onto the tongue of the installed siding board.

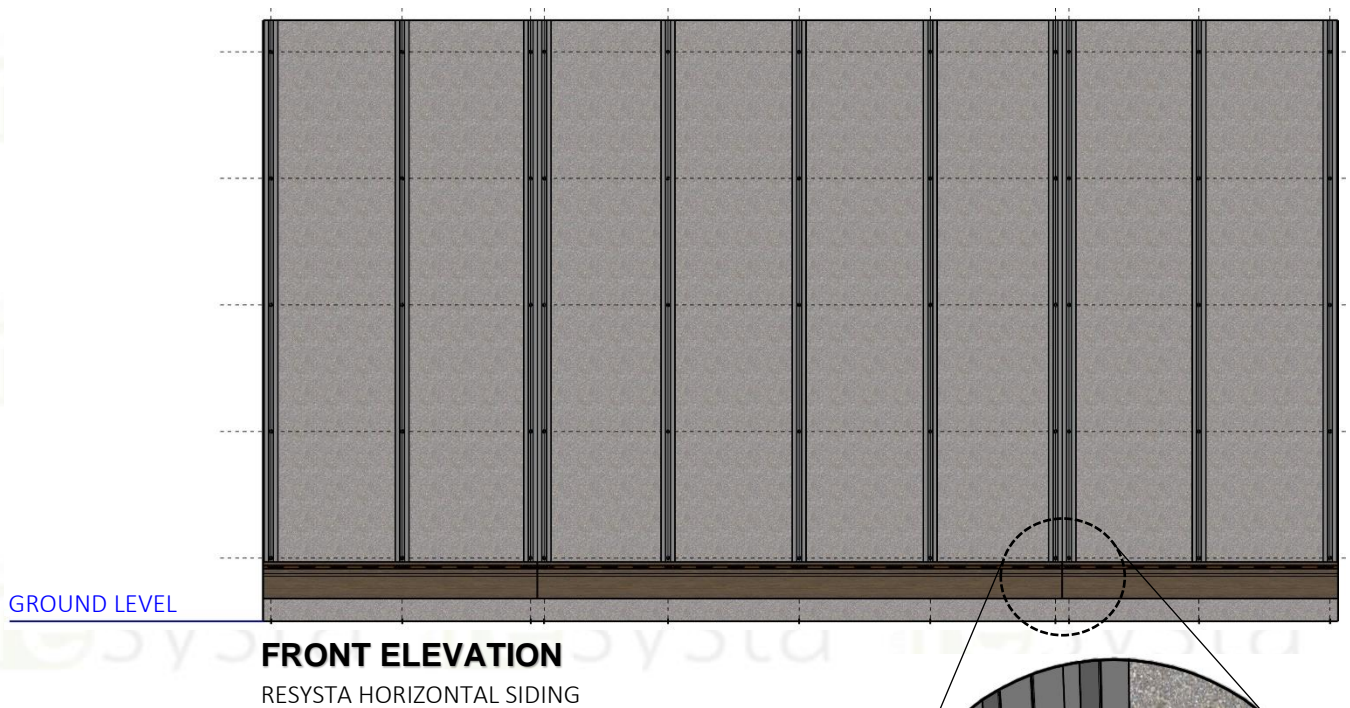

**Note:**

Ensure a 1mm gap expansion using shim with a space gap of 13mm from one board to another board.

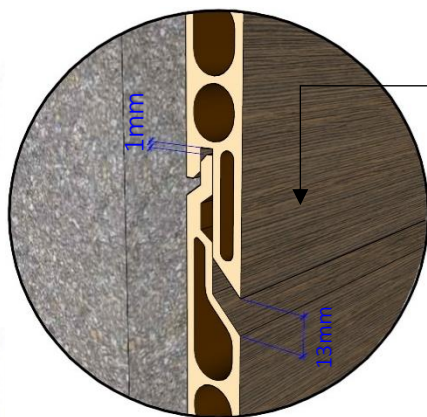

CPRB 70  
Rhombus Profile

Reverse RESSHTC10 Hat Channel

RESSJS10 Starter J Strip

CPRB 70 Rhombus Profile

CPSS 25  
25mm Shoulder Stainless  
Steel Siding Screw

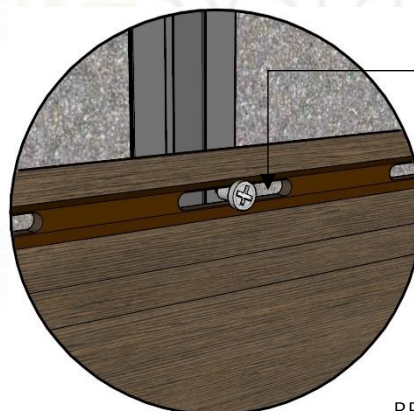

Thermal  
Expansion Hole



**Pinning** is a way to control the direction of expansion of the Resysta Siding board, each board needs to be fixed at the middle of the board.

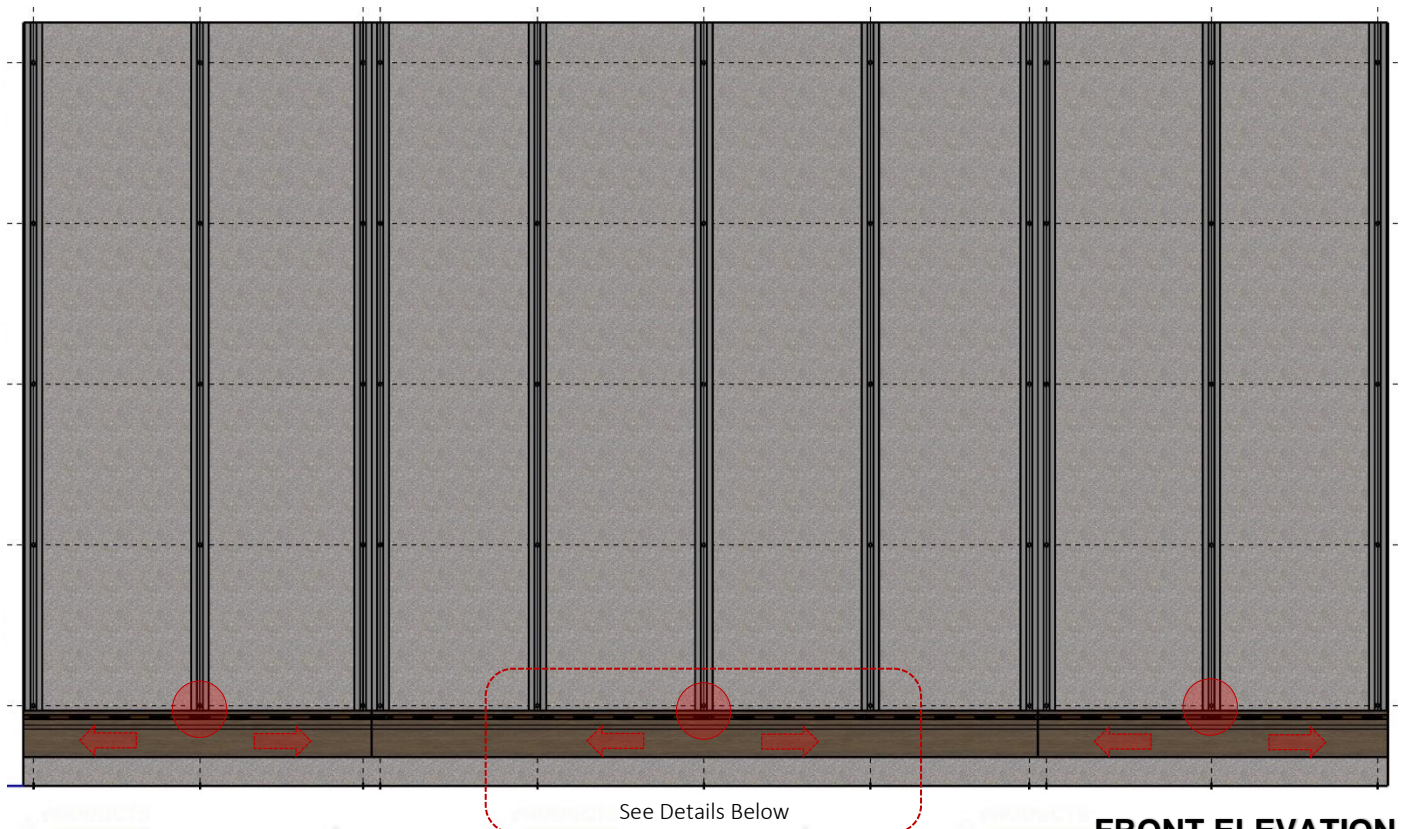

**FRONT ELEVATION**  
RESYSTA HORIZONTAL SIDING

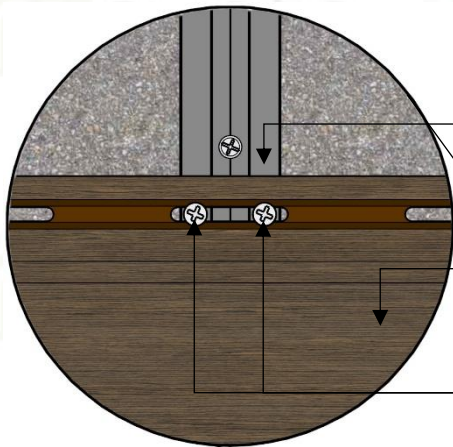

Reverse RESHTC10 Hat Channel

CPRB 70 Rhombus Profile

Double CPSS 25  
25mm Shoulder Stainless Steel Siding Screw

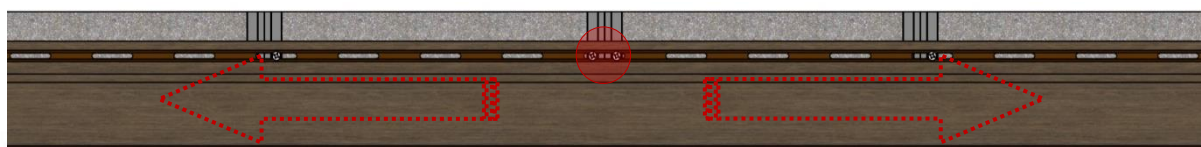
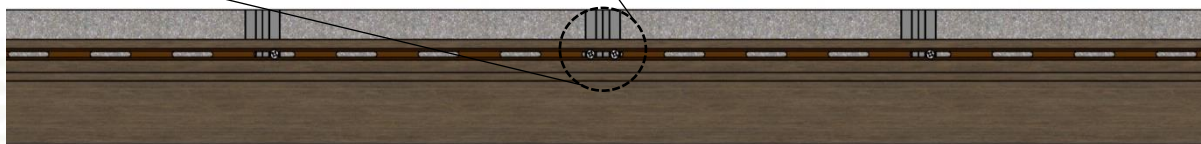

EXPANSION DIRECTION

EXPANSION DIRECTION

### **Pinning Location**

Every board should have pin on the middle of the Resysta Siding board allow for right or left side expansion direction.

### STEP 3.1.9

Continue installing siding boards until siding is finished.

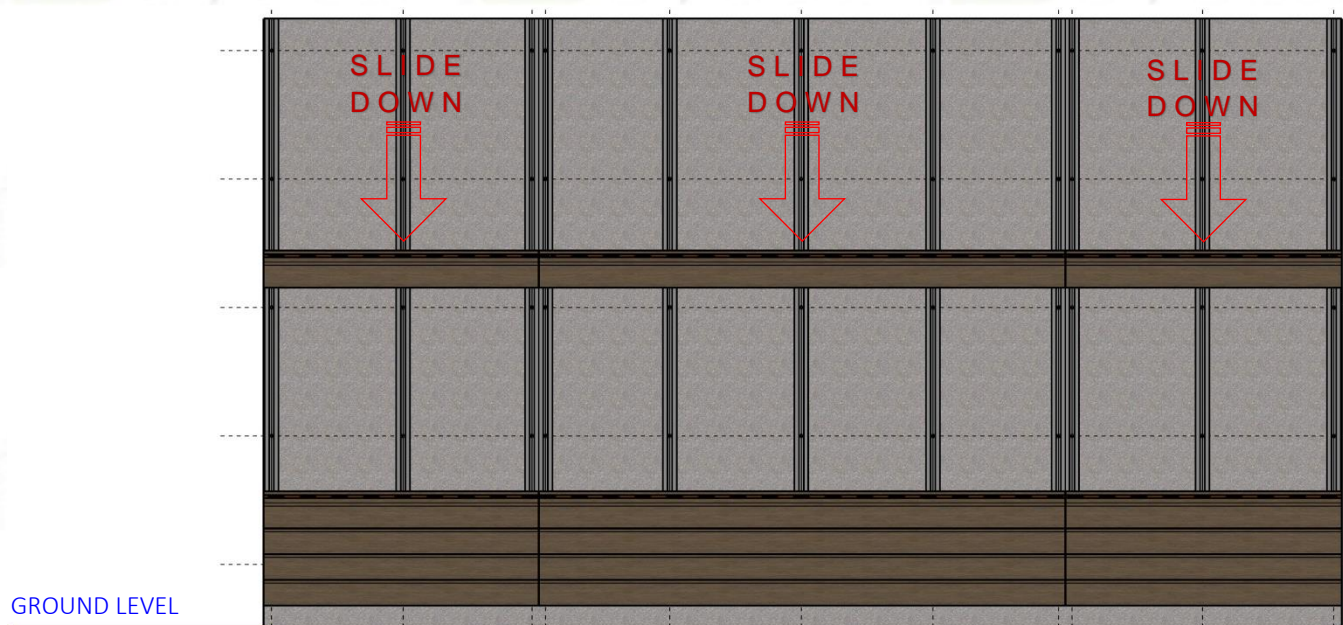

### FRONT ELEVATION

RESYSTA HORIZONTAL SIDING



### FRONT ELEVATION

RESYSTA HORIZONTAL SIDING





**ISOMETRIC DETAIL**  
RESYSTA HORIZONTAL SIDING

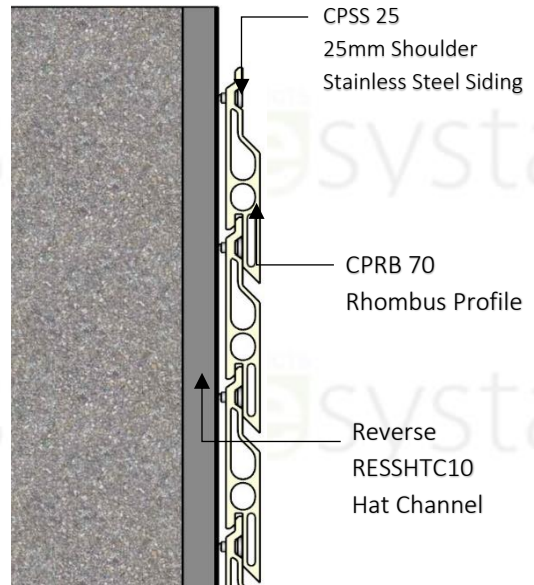

**SECTION**  
RESYSTA HORIZONTAL SIDING

#### SECTION 4 – Air Barrier – Requirements

For all of the installation options it is crucial to allow the uninterrupted flow of air from the bottom to the top of the wall system. This creates a chimney effect which provides not only moisture wicking but also cooling behind the Resysta siding.

Air flow must be able to release at the top of the construction. For that reason, a 1m3m gap between the top of the Resysta siding board and the Parapet Wall Cap Flashing is necessary. The same size gap is needed between the face of the Resysta siding board and the Parapet Wall Cap Flashing. This should also be followed when using the J channel at the top of the wall.

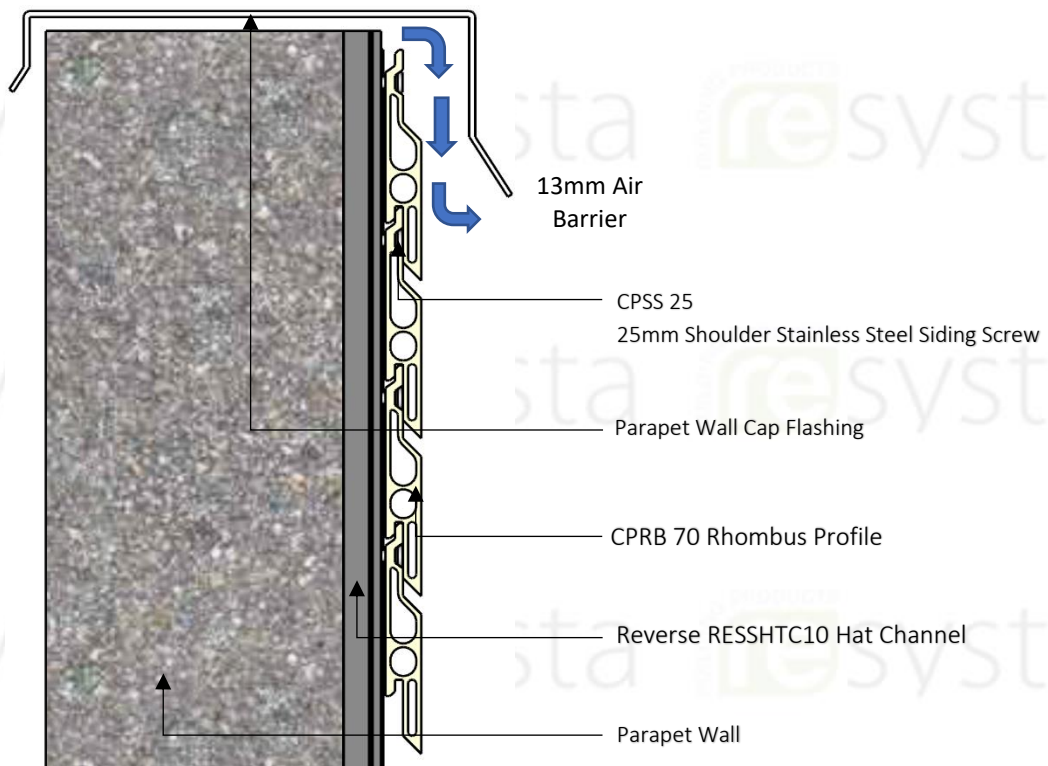

**SIDE ELEVATION**

## SECTION 5 – Finishing Corner Details

### HORIZONTAL OUTSIDE CORNERS

Outside corner trim should be pre applied prior to installing siding boards. The siding board end should be miter cut at a 45 degree angle to match up with the outside corner internal web. Follow the gap guide when installing the siding board to allow for expansion and contraction within the outside corner trim. Install horizontal siding per previous sections. When using aluminum hat channel for outside corner application, installer should reverse and attaché hat channel so that the flanges meet.

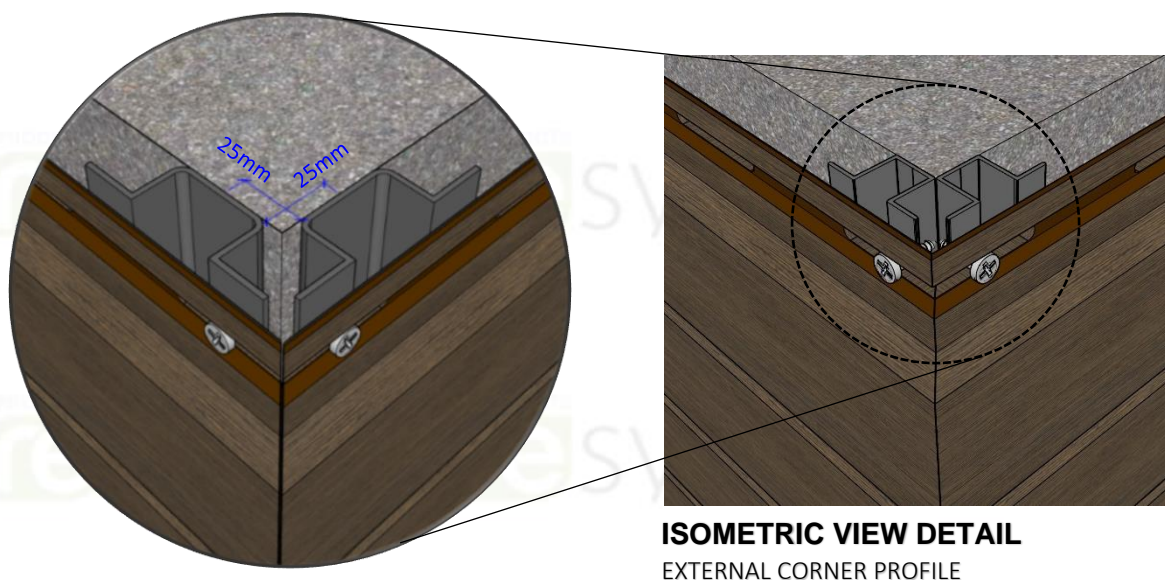
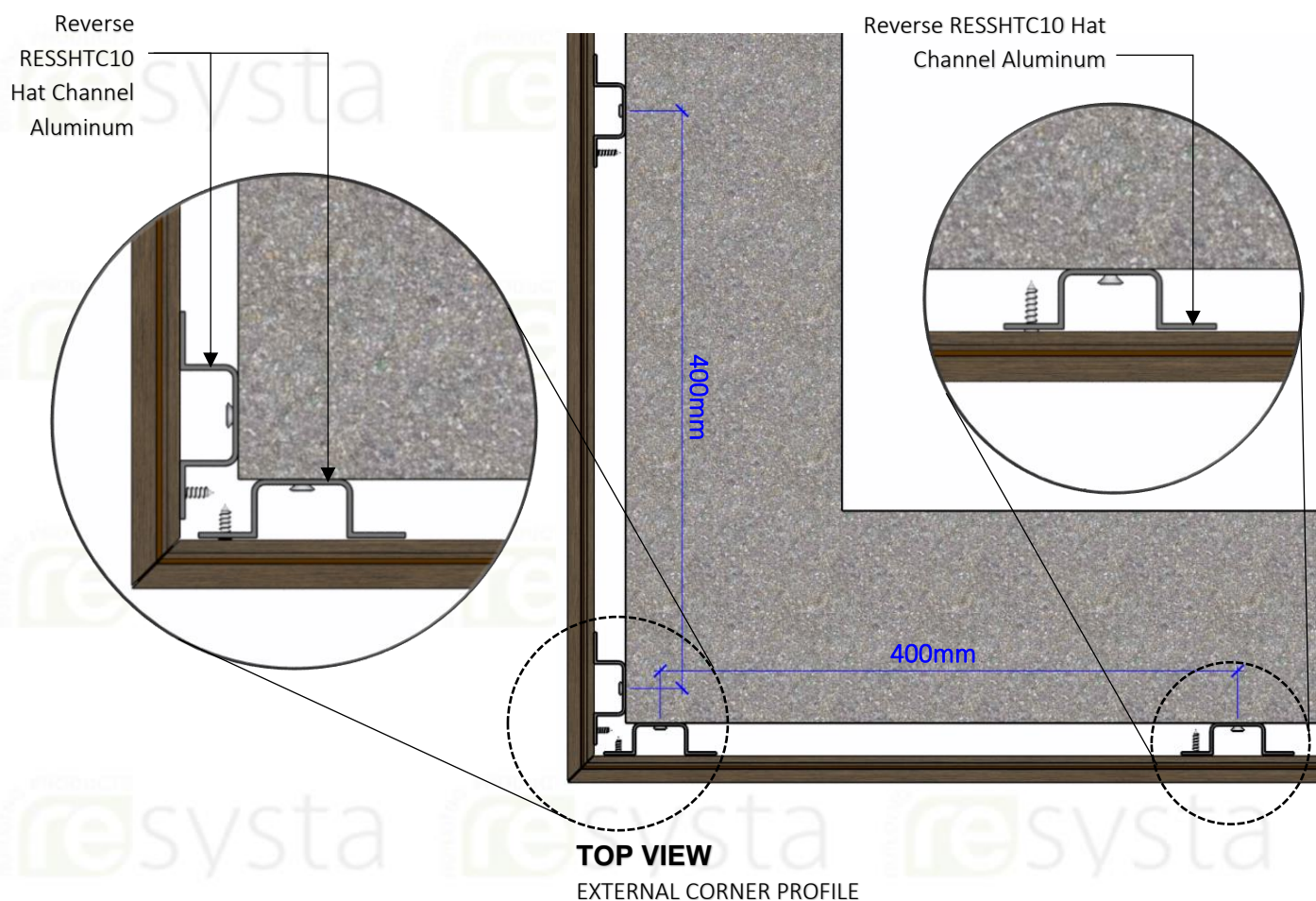



## HORIZONTAL INSIDE CORNERS

Inside corner trim should be pre-applied prior to installing siding boards. The starter strip for the first board should be installed butted against the corner trim, not overlapping the corner trim attachment flange. Follow the gap guide when installing the siding board to allow for expansion and contraction within the inside corner trim. Install horizontal siding per previous sections.

### Note

The corners of the Resysta siding inside of the trim need to be mitered. This gives more room for expansion inside of the trim and leaves more of the face of the siding when it contracts.

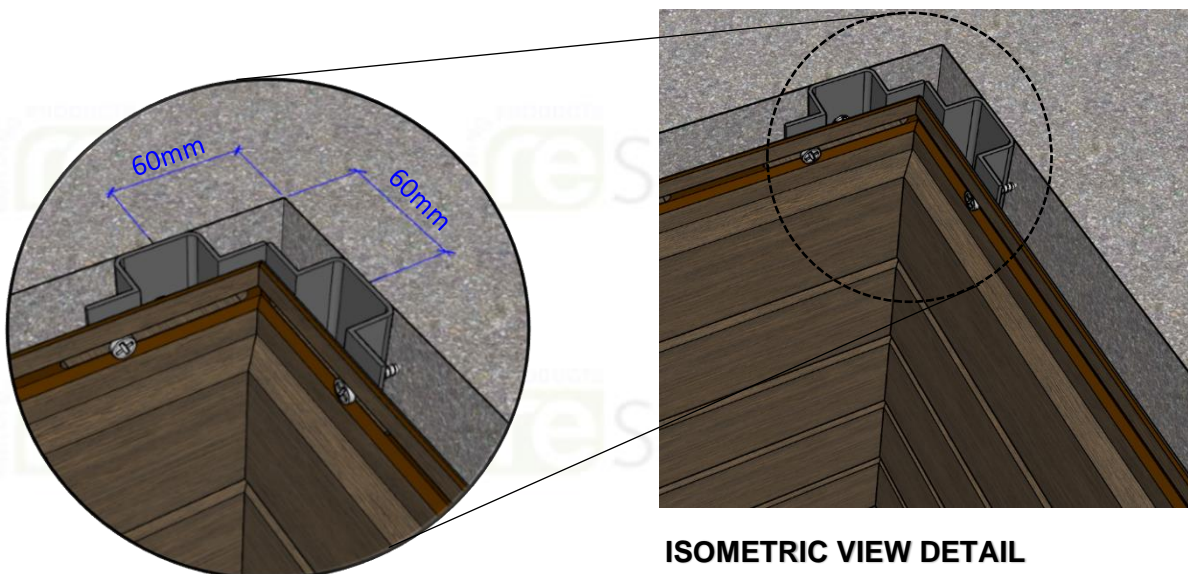
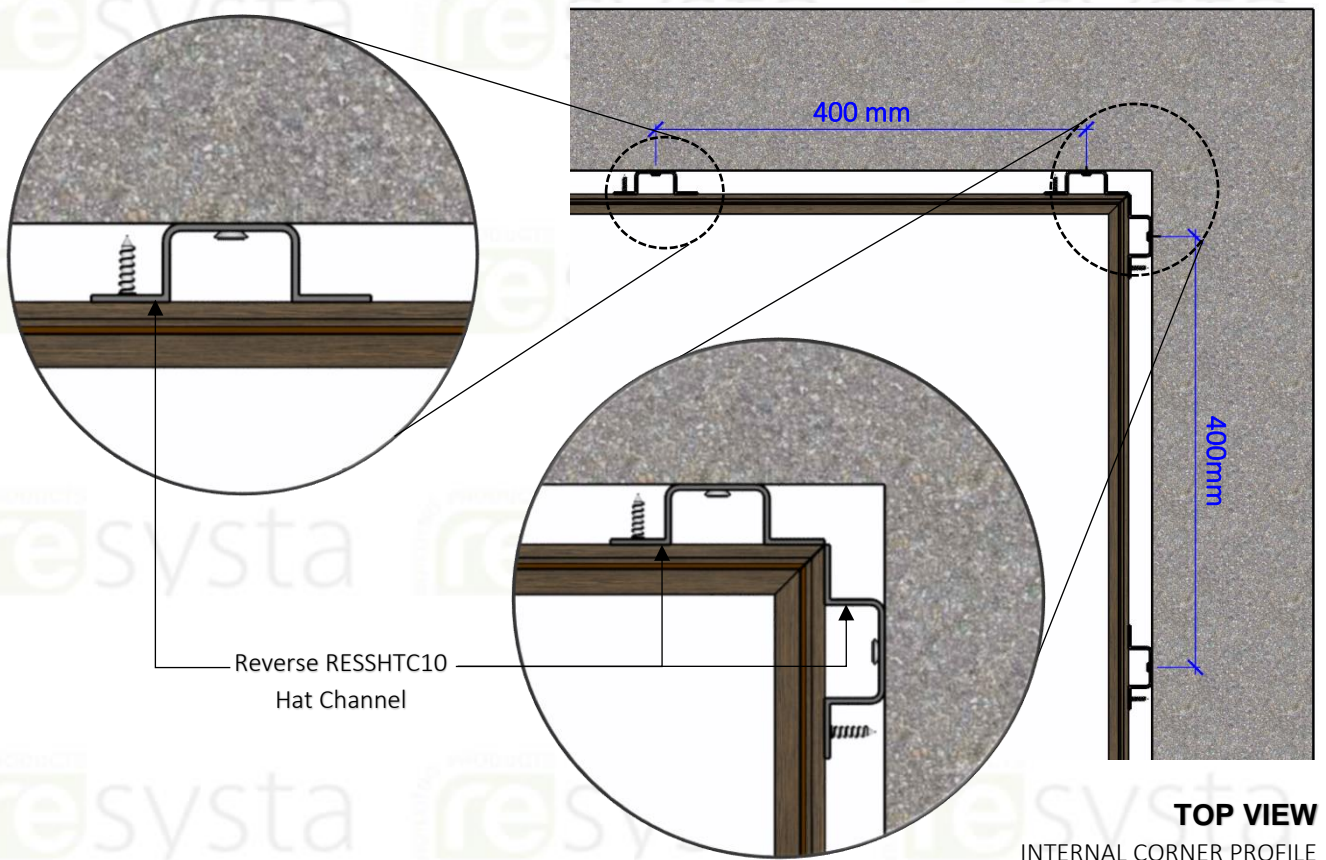

## SECTION 6 – Primer and Stain System

Resysta recommends using approved water-based stain and sealant system.

### 3. Safety Warning

Resysta® Products do not present an inhalation, ingestion, or contact health hazard unless subjected to operations such as sawing, sanding, or machining which result in the generation of airborne particulate. This product contains amorphous silica. Respirable amorphous silica limits are specified by OSHA. Exposure to respirable (fine) silica dust depends on a variety of factors, including activity rate (e.g. cutting rate), method of handling, ventilation, environmental conditions (e.g. weather conditions, workstation orientation), and engineering control measures used. Exposures to respirable amorphous silica above limits established by OSHA are not expected during the normal use of this product. Amorphous silica, has been shown to cause silicosis, and has been identified by the State of California, IARC and NTP as a known human carcinogen. The risk of developing silicosis is dependent upon the exposure intensity and duration. It is recommended that a NIOSH approved particulate respirator be worn whenever working with this product results in airborne dust exposure.

#### **Please direct product inquiries to:**

Resysta Asia  
3B Bury Road  
Singapore 119823  
Office No. 6272-4505

Email: [info@resysta-asia.com](mailto:info@resysta-asia.com)