

INSIDE CORNER MOLD
(SEE SUB-DETAIL ATVSD-1.2)

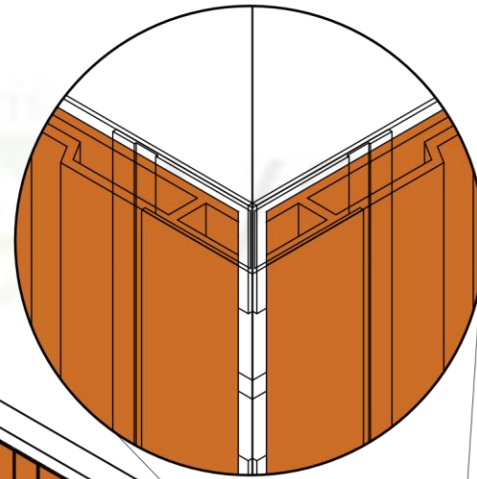

OUTSIDE CORNER MOLD
(SEE SUB-DETAIL ATVSD-1.3)

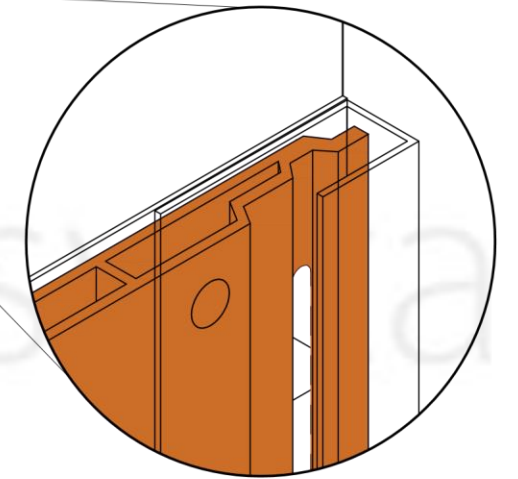

J-MOLD
(SEE SUB-DETAIL ATVSD-1.4)

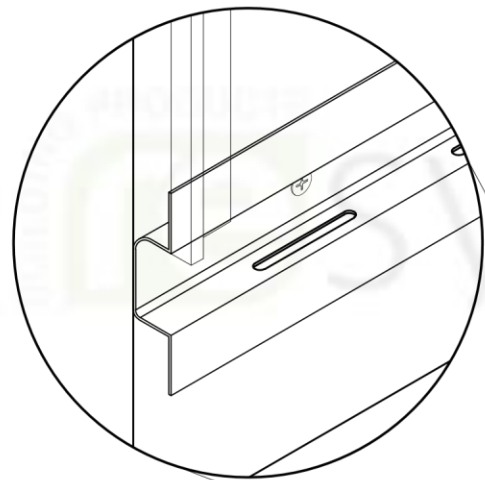

STARTET J STRIP
(SEE SUB-DETAIL ATVSD-1.1)

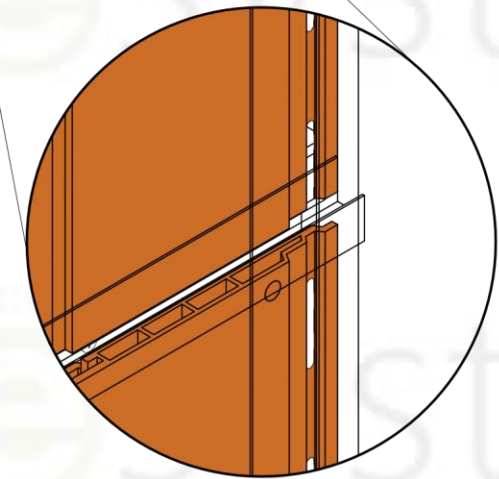

H-MOLD
(SEE SUB-DETAIL ATVSD-1.5)

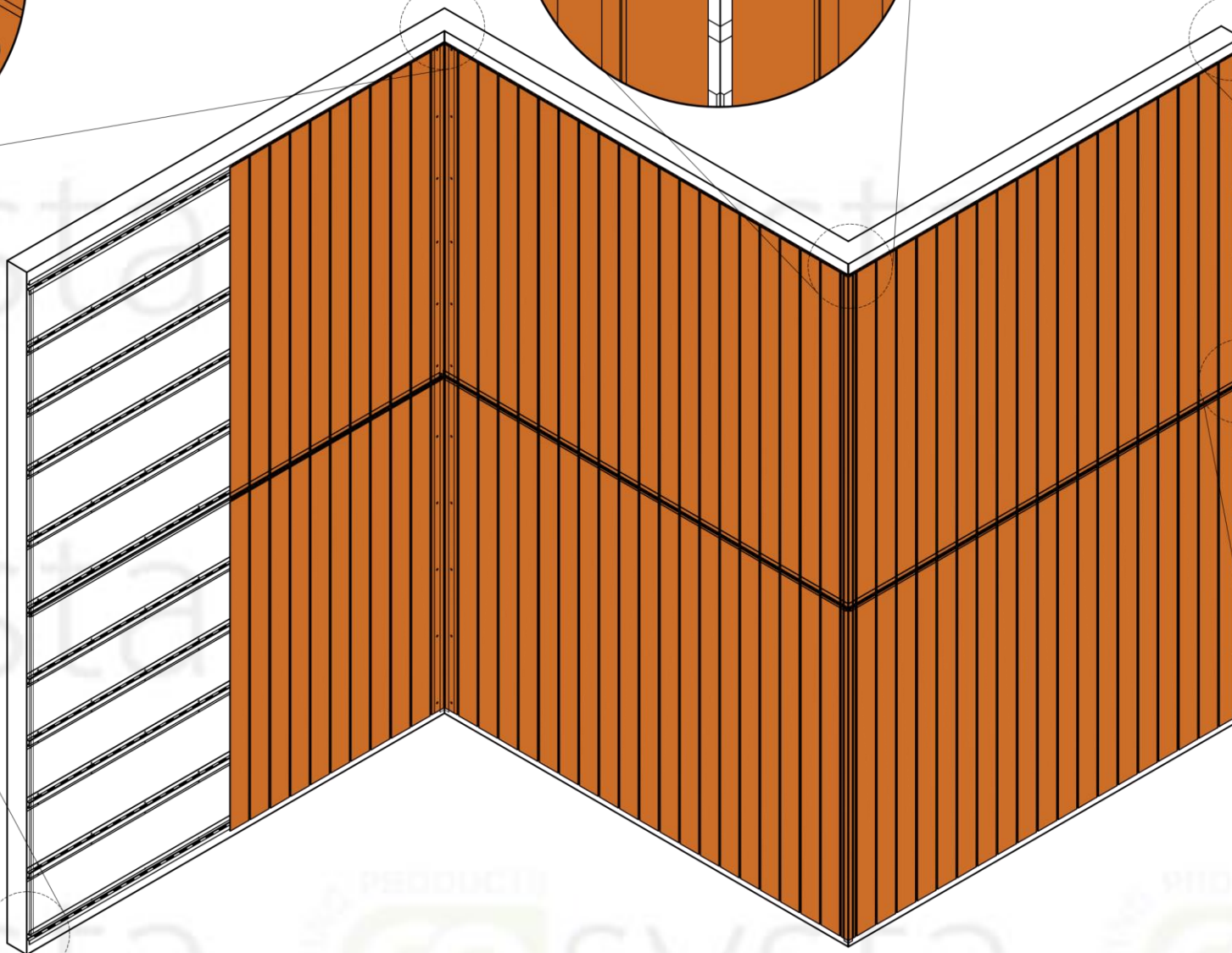

ISOMETRIC VIEW

1
ATVSD-1

ALUMINUM TRIM VERTICAL SIDING DETAIL (ATVSD)

N.T.S



NOTE

THIS DRAWING AS AN INSTRUMENT OF SERVICE, IS THE PROPERTY OF RESYSTA AND AS SUCH MUST NOT BE REPRODUCED OR COPIED IN PART OR IN WHOLE WITHOUT THE PERMISSION OF THE AUTHOR.

TITLE
ALUMINUM TRIM VERTICAL SIDING DETAIL

SPECIFICATION	
TYPICAL DRAWING DETAIL	
CAD BY: M.T.C.	CHECKED BY: C.R.E.

SHEET CONTENT
ISOMETRIC VIEW
BLOW-UP DETAIL

SHEET SIZE	DRAWING NO.
A3	ATVSD-01
DATE	REVISION
03.01.23	0

CONTINENT
RESYSTA ASIA

DIMENSION LEGEND

Millimeter (mm)
Inches (") / Foot (')

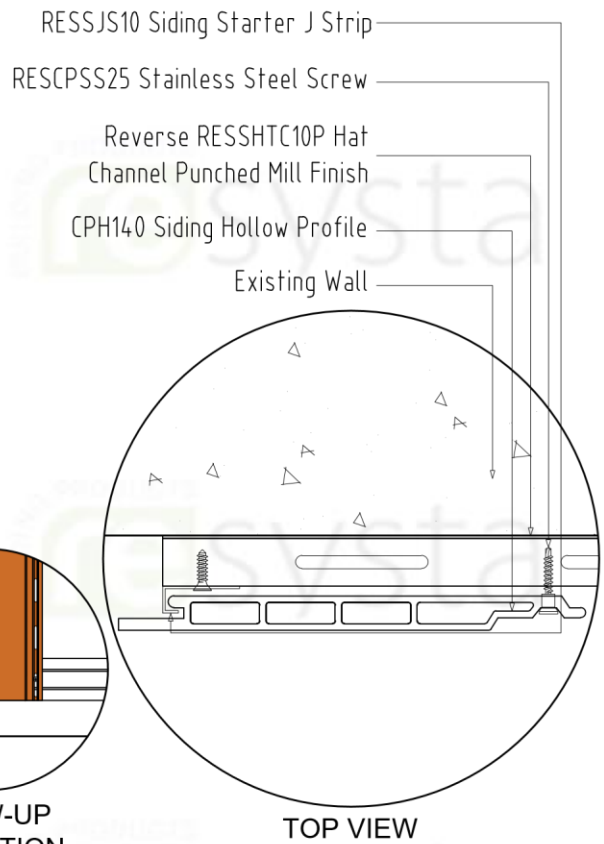
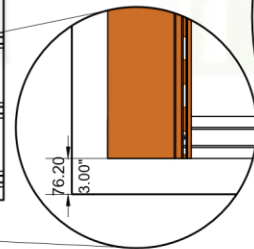
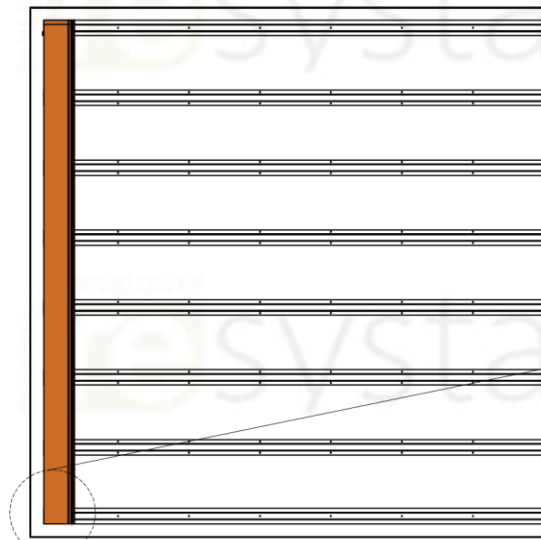
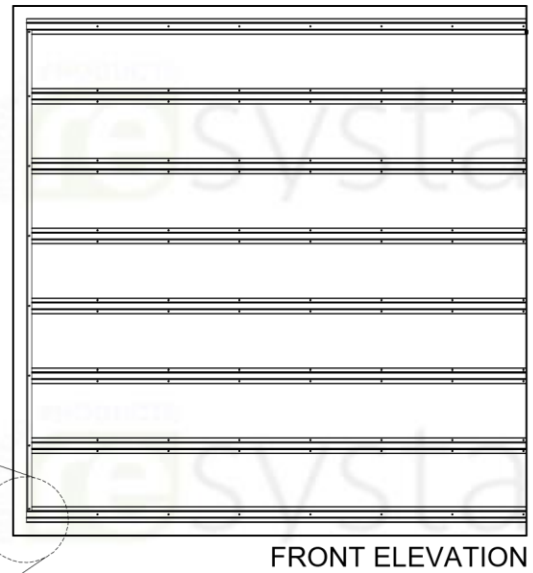
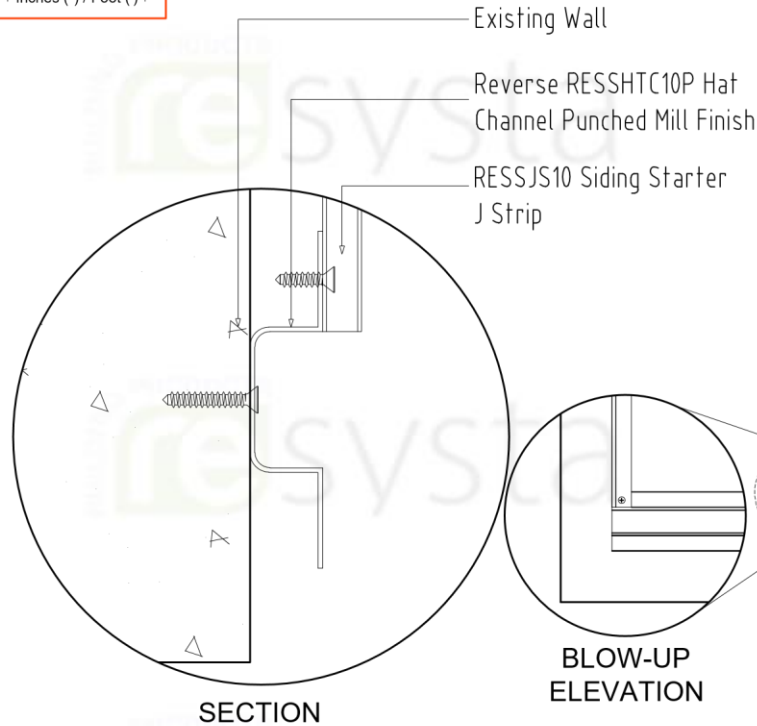

SUB-DETAIL
ATVSD 1.1
N.T.S

Note:

Aluminum starter strip is required to install the Resysta siding board. Attach the starter strip at the bottom of the battens following the fastener and spacing recommendations. The Resysta siding boards will hang 12.7mm below the bottom of the starter strip therefore the starter strip should be attached accordingly as per the pre plan layout.



NOTE

THIS DRAWING AS AN INSTRUMENT OF SERVICE, IS THE PROPERTY OF RESYSTA AND AS SUCH MUST NOT BE REPRODUCED OR COPIED IN PART OR IN WHOLE WITHOUT THE PERMISSION OF THE AUTHOR.

TITLE	SHEET CONTENT	CONTINENT
ALUMINUM TRIM VERTICAL SIDING SUB-DETAIL	ELEVATION	RESYSTA ASIA
	BLOW-UP DETAIL	
	SECTION	
SPECIFICATION	TOP VIEW	DATE
TYPICAL DRAWING DETAIL	DRAWING NO.	03.01.23
	ATVSD-02	CHECKED BY:
	M.T.C.	C.R.E.

DIMENSION LEGEND

Millimeter (mm)
Inches (") / Foot (')

- 10mm Ø Veneer Cap
- Reverse RESHTC10P Hat Channel Punched Mill Finish
- CPH140 Siding Hollow Profile
- RESSIC10 Inside Corner Mold
- Gap_Refer to Table 1.4
- RESCPSS25 Stainless Steel Screw
- Existing Wall

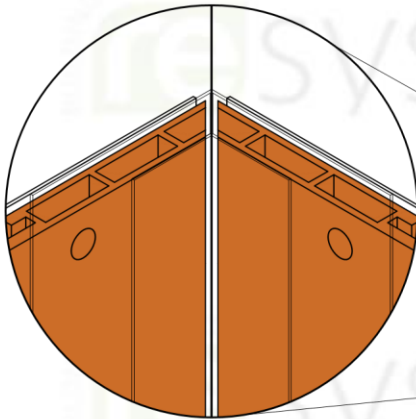

BLOW-UP ISOMETRIC

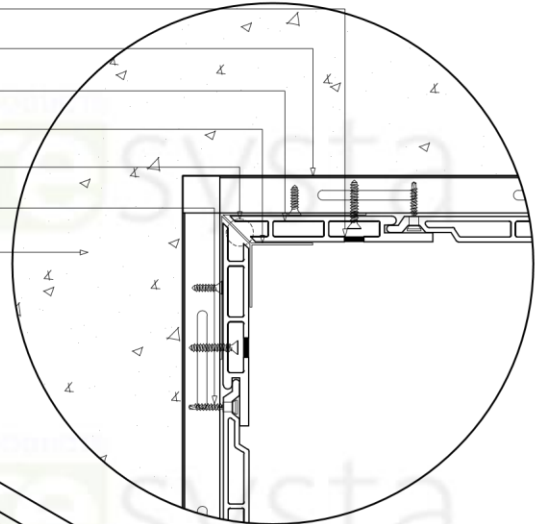

TOP VIEW

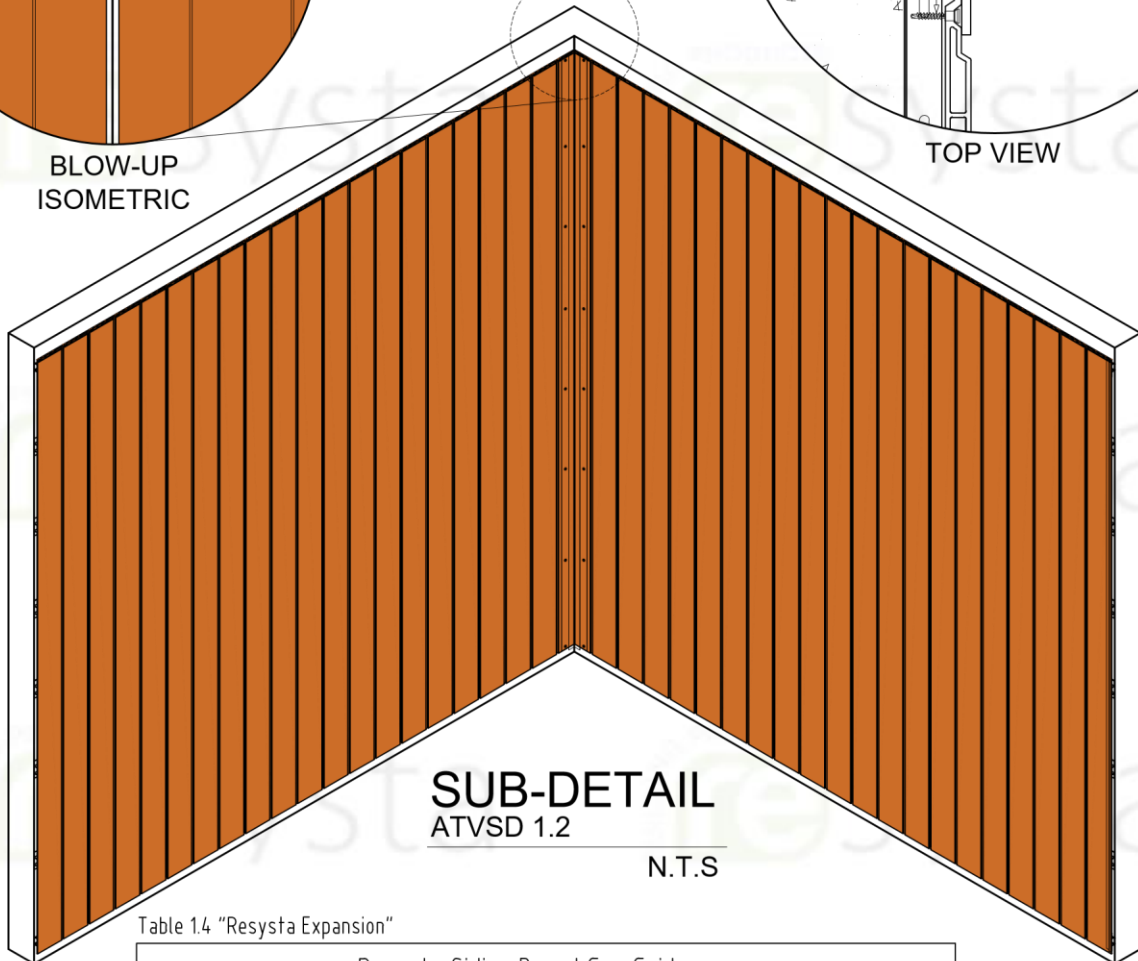

SUB-DETAIL

ATVSD 1.2

N.T.S

ISOMETRIC VIEW

Table 1.4 "Resysta Expansion"

Resysta Siding Board Gap Guide					
Temperature at Installation	Aluminum Trim Gap of Siding Boards				H-Channel Gap
	Below 0°C	15°C	20°C	30°C	
Amount for Siding Profile - Length of 2900mm.	10mm	7mm	3mm	0mm	6mm

Note :

Inside corner trim should be pre-applied prior to installing siding boards. The starter strip for the first board should be installed butted against the corner trim, not overlapping the corner trim attachment. Follow the gap guide when installing the siding board to allow for expansion and contraction within the inside corner trim.



NOTE

THIS DRAWING AS AN INSTRUMENT OF SERVICE, IS THE PROPERTY OF RESYSTA AND AS SUCH MUST NOT BE REPRODUCED OR COPIED IN PART OR IN WHOLE WITHOUT THE PERMISSION OF THE AUTHOR.

TITLE	SHEET CONTENT	CONTINENT
ALUMINUM TRIM VERTICAL SIDING SUB-DETAIL	ISOMETRIC VIEW	RESYSTA ASIA
	BLOW-UP ISOMETRIC	
	TOP VIEW	
SPECIFICATION	DRAWING NO.	DATE
TYPICAL DRAWING DETAIL	ATVSD-03	03.01.23
	CAD BY:	CHECKED BY:
	M.T.C.	C.R.E.

DIMENSION LEGEND

Millimeter (mm)
Inches (") / Foot (')

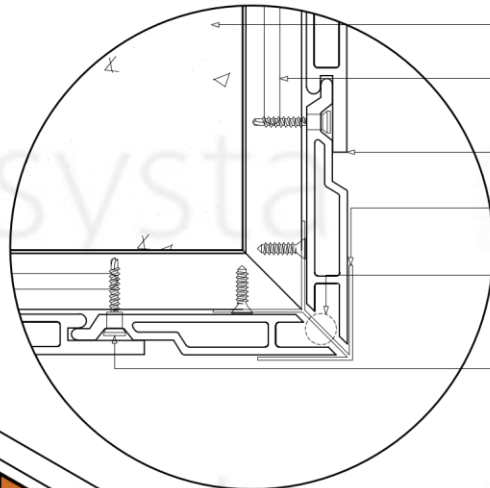

- Existing Wall
- Reverse RESSHTC10P Hat Channel Punched Mill Finish
- CPH140 Siding Hollow Profile
- RESSOC10 Outside Corner
- Gap_Refer to Table 1.4
- RESCPSS25 Stainless Steel Screw

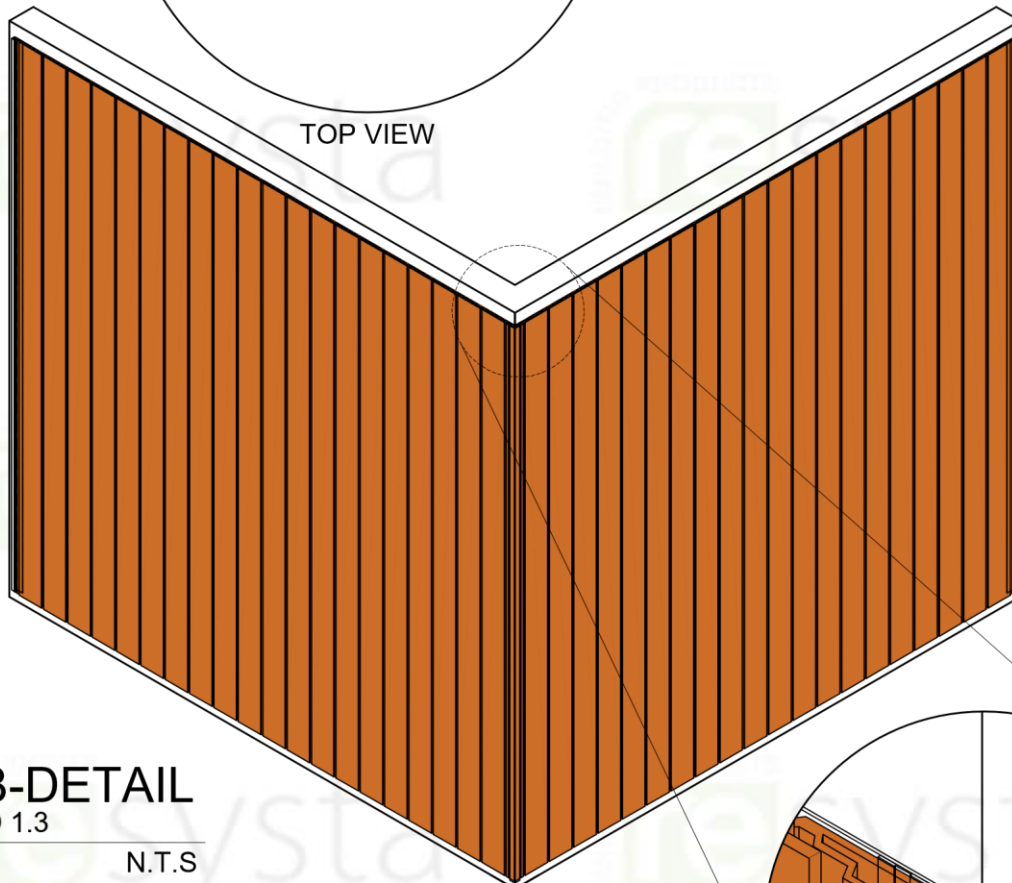

TOP VIEW

ISOMETRIC VIEW

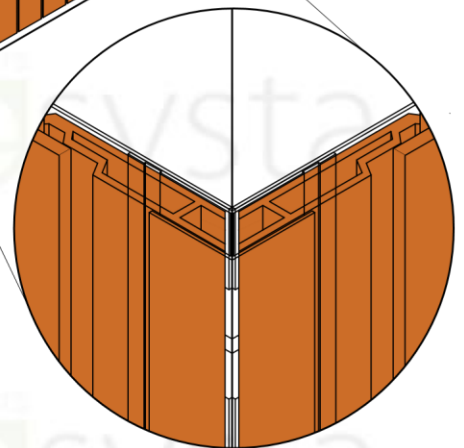

BLOW-UP ISOMETRIC

SUB-DETAIL
ATVSD 1.3

N.T.S

Table 1.4 "Resysta Expansion"

Resysta Siding Board Gap Guide					
Temperature at Installation	Aluminum Trim Gap of Siding Boards				H-Channel Gap
	Below 0°C	15°C	20°C	30°C	
Amount for Siding Profile - Length of 2900mm.	10mm	7mm	3mm	0mm	6mm

Note :

Outside corner trim should be pre applied prior to installing siding boards. The starter strip for the first board should be installed butted against the corner trim, not overlapping the corner trim attachment. The siding board end that is inserted into the outside corner should be miter cut at a 45 degree angle to match up with the outside corner internal web.



NOTE

THIS DRAWING AS AN INSTRUMENT OF SERVICE, IS THE PROPERTY OF RESYSTA AND AS SUCH MUST NOT BE REPRODUCED OR COPIED IN PART OR IN WHOLE WITHOUT THE PERMISSION OF THE AUTHOR.

TITLE	SHEET CONTENT	CONTINENT
ALUMINUM TRIM VERTICAL SIDING SUB-DETAIL	ISOMETRIC VIEW	RESYSTA ASIA
	BLOW-UP ISOMETRIC	
	TOP VIEW	
SPECIFICATION	DRAWING NO.	DATE
TYPICAL DRAWING DETAIL	ATVSD-04	03.01.23
	CAD BY:	CHECKED BY:
	M.T.C.	C.R.E.

DIMENSION LEGEND

Millimeter (mm)
Inches (") / Foot (')

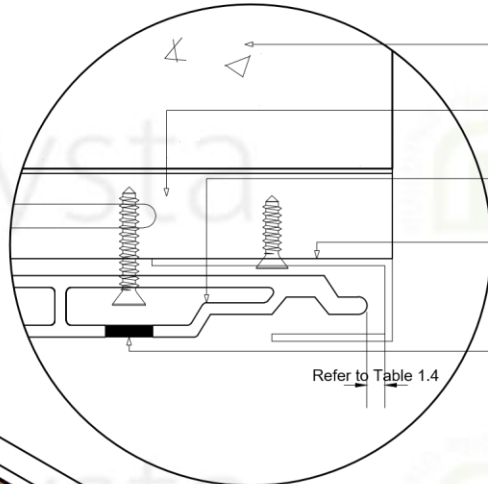

- Existing Wall
- Reverse RESSHTC10P Hat Channel Punched Mill Finish
- CPH140 Siding Hollow Profile
- RESSJM10 J Mold
- 10mm ϕ Veneer Cap

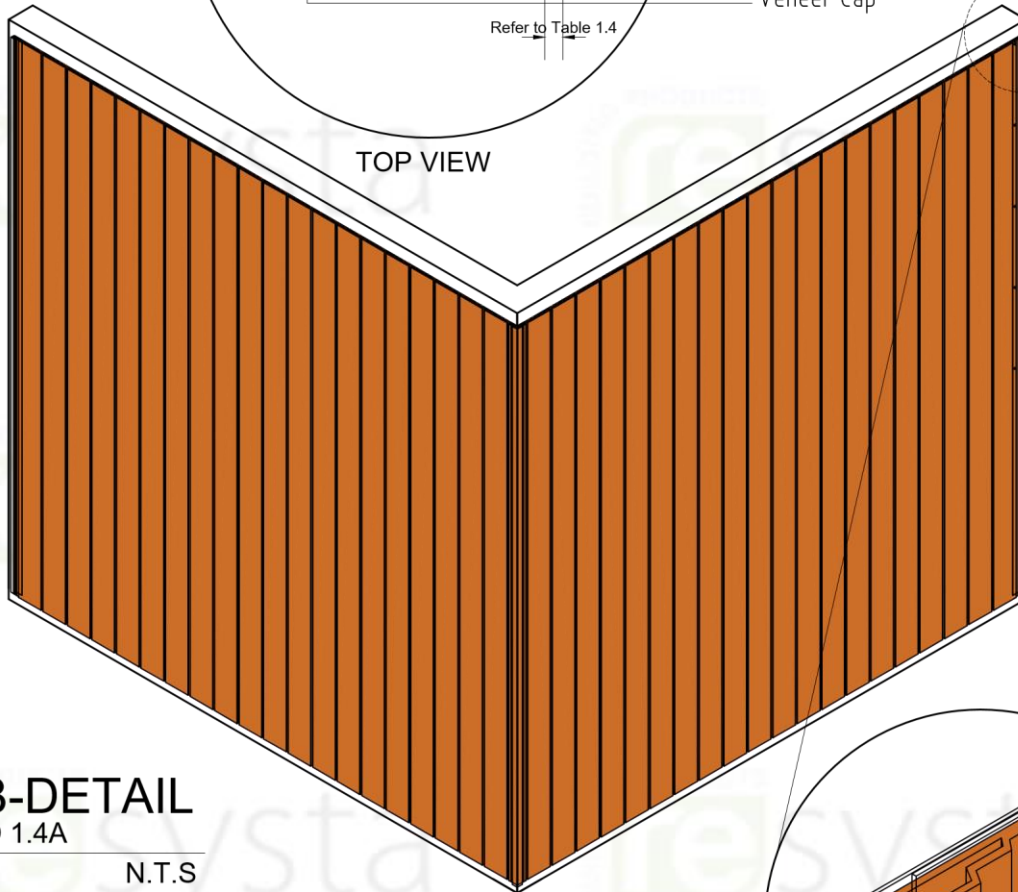

TOP VIEW

ISOMETRIC VIEW



BLOW-UP ISOMETRIC

SUB-DETAIL
ATVSD 1.4A

N.T.S

Table 1.4 "Resysta Expansion"

Resysta Siding Board Gap Guide					
Temperature at Installation	Aluminum Trim Gap of Siding Boards				H-Channel Gap
	Below 0°C	15°C	20°C	30°C	
Amount for Siding Profile - Length of 2900mm.	10mm	7mm	3mm	0mm	6mm

Note :

When a siding board in either a horizontal or vertical application terminates into a wall, eave, window, door etc. a J-channel should be used to cover the exposed end of the siding board. The J-channel should also be used along the bottom of a vertical installation. J-channel trim should be pre-applied prior to installing siding boards.



NOTE

THIS DRAWING AS AN INSTRUMENT OF SERVICE, IS THE PROPERTY OF RESYSTA AND AS SUCH MUST NOT BE REPRODUCED OR COPIED IN PART OR IN WHOLE WITHOUT THE PERMISSION OF THE AUTHOR.

TITLE	SHEET CONTENT	CONTINENT
ALUMINUM TRIM VERTICAL SIDING SUB-DETAIL	ISOMETRIC VIEW	RESYSTA ASIA
	BLOW-UP ISOMETRIC	
	TOP VIEW	
SPECIFICATION	DRAWING NO.	DATE
TYPICAL DRAWING DETAIL	ATVSD-05	03.01.23
	CAD BY:	CHECKED BY:
	M.T.C.	C.R.E.

DIMENSION LEGEND

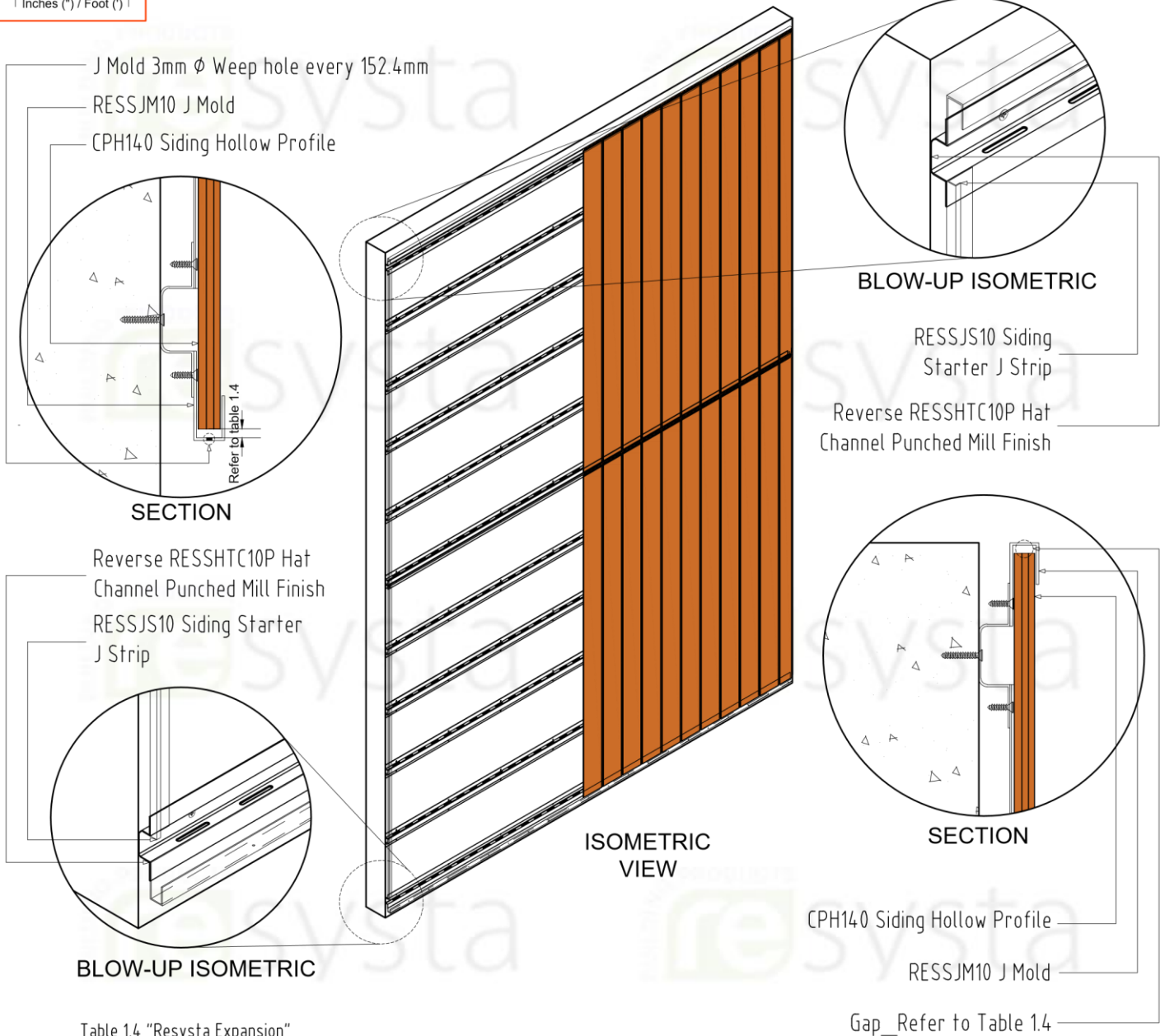
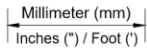

Table 1.4 "Resysta Expansion"

Resysta Siding Board Gap Guide					
Temperature at Installation	Aluminum Trim Gap of Siding Boards				H-Channel Gap
	Below 0°C	15°C	20°C	30°C	
Amount for Siding Profile - Length of 2900mm.	10mm	7mm	3mm	0mm	6mm

CPH140 Siding Hollow Profile
RESSJM10 J Mold
Gap_Refer to Table 1.4

SUB-DETAIL
ATVSD 1.4B

N.T.S

Note :

When a siding board in either a horizontal or vertical application terminates into a wall, eave, window, door etc. a J-channel should be used to cover the exposed end of the siding board. The J-channel should also be used along the bottom of a vertical installation. J-channel trim should be pre-applied prior to installing siding boards.



NOTE

THIS DRAWING AS AN INSTRUMENT OF SERVICE, IS THE PROPERTY OF RESYSTA AND AS SUCH MUST NOT BE REPRODUCED OR COPIED IN PART OR IN WHOLE WITHOUT THE PERMISSION OF THE AUTHOR.

TITLE	SHEET CONTENT	CONTINENT	
ALUMINUM TRIM VERTICAL SIDING SUB-DETAIL	ISOMETRIC VIEW	RESYSTA ASIA	
	BLOW-UP ISOMETRIC SECTION		
SPECIFICATION	DRAWING NO.	DATE	
	ATVSD-06	03.01.23	
	CAD BY:	CHECKED BY:	
TYPICAL DRAWING DETAIL	M.T.C.	C.R.E	

DIMENSION LEGEND

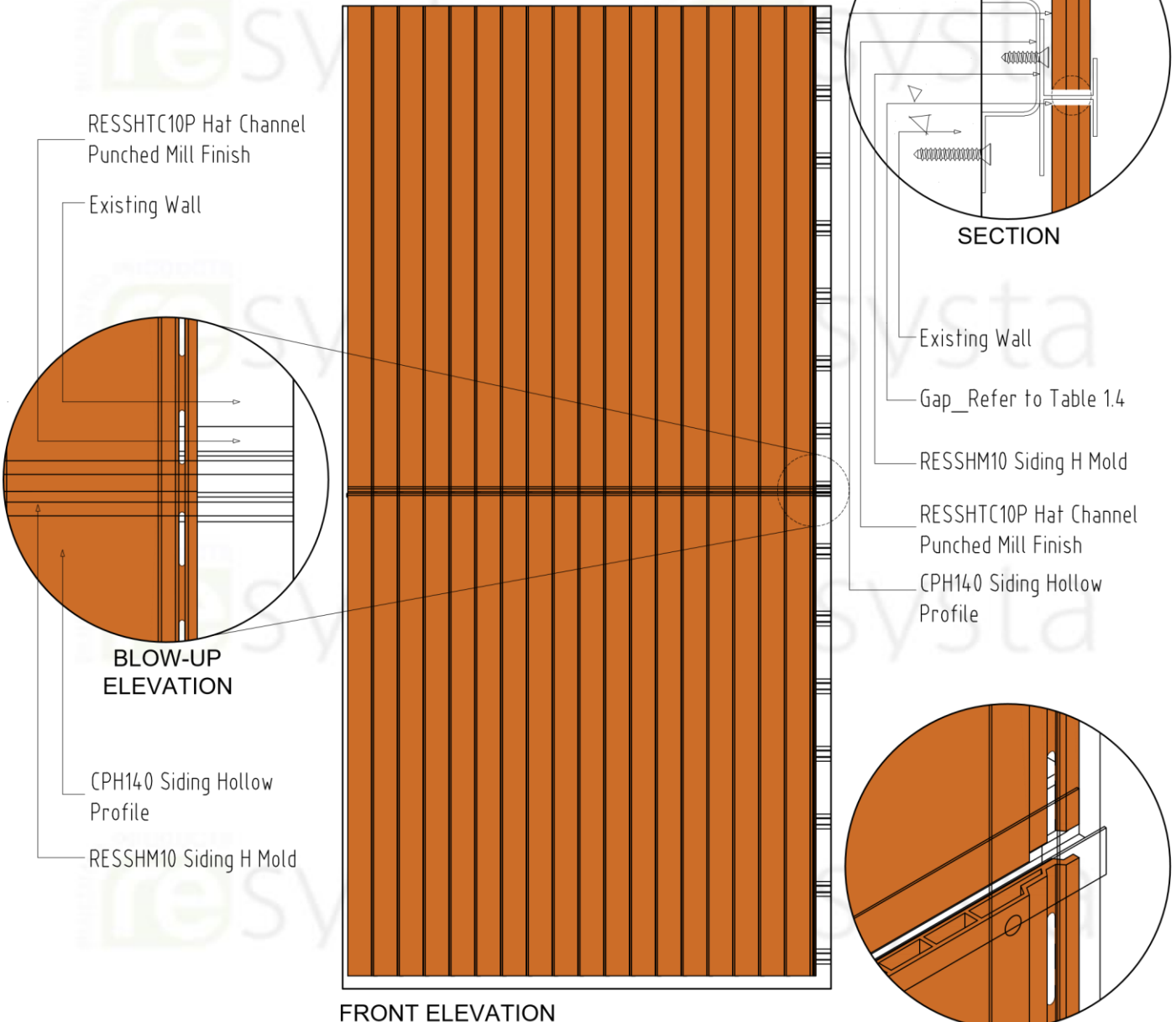
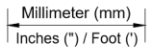

Table 1.4 "Resysta Expansion"

Resysta Siding Board Gap Guide					
Temperature at Installation	Aluminum Trim Gap of Siding Boards				H-Channel Gap
	Below 0°C	15°C	20°C	30°C	
Amount for Siding Profile - Length of 2900mm.	10mm	7mm	3mm	0mm	6mm

SUB-DETAIL
ATVSD 1.5

N.T.S

Note :
An H-Channel should be installed at each board abutment joint to cover the ends of the Resysta siding board. This is a option for installations using 3 or more boards abutted end-to-end



NOTE
THIS DRAWING AS AN INSTRUMENT OF SERVICE, IS THE PROPERTY OF RESYSTA AND AS SUCH MUST NOT BE REPRODUCED OR COPIED IN PART OR IN WHOLE WITHOUT THE PERMISSION OF THE AUTHOR.

TITLE	SHEET CONTENT	CONTINENT	
ALUMINUM TRIM VERTICAL SIDING SUB-DETAIL	ELEVATION	RESYSTA ASIA	
	BLOW-UP DETAIL		
	SECTION		
SPECIFICATION	ISOMETRIC VIEW	DATE	
	DRAWING NO.	ATVSD-07	03.01.23
	CAD BY:	M.T.C.	CHECKED BY: C.R.E
TYPICAL DRAWING DETAIL			